

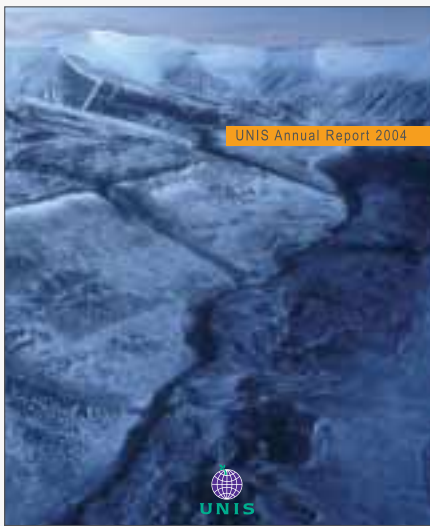

UNIS Annual Report 2004





Magnificent autumn light after the first snowfall in Berzeliusdalen, Western Svalbard.  
Photo: Marta Slubowska

## CONTENTS

A year of major challenges	3
Et år med store utfordringer	4
Report of the Board of Directors	6
Styrets beretning 2004	10
Statistics / Statistikk	13
Resultatregnskap	14
Balanse	15
Arctic Biology	17
Arctic Geology	21
Arctic Geophysics	25
Arctic Technology	29
Student Body Annual Report	32
Scientific publications 2004	33
Guest lecturers 2004	38

Wind, precipitation and temperature in Longyearbyen in 2004  
Vind, nedbør og temperatur i Longyearbyen i 2004

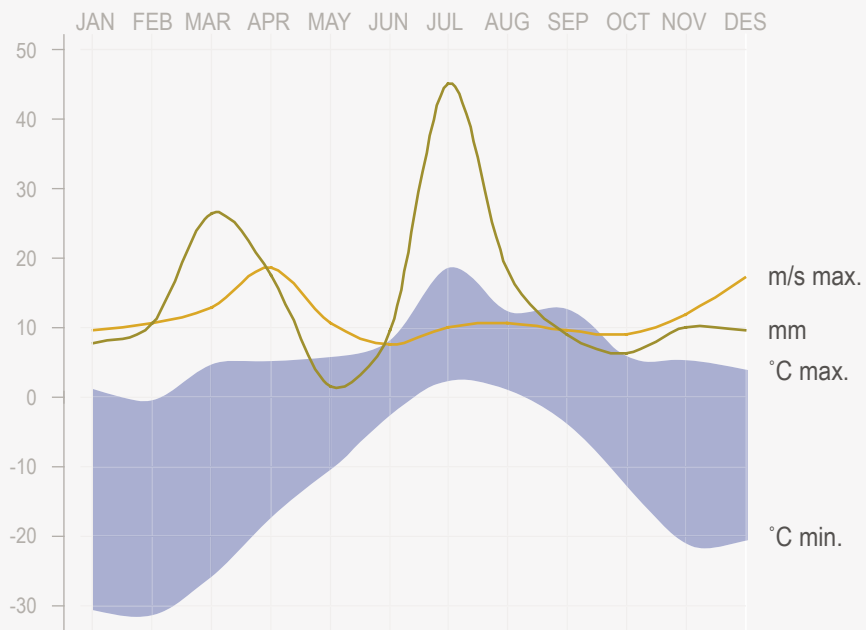

## A year of major challenges

Few institutions of research and higher education in Norway – or indeed anywhere else for that matter – can boast a more fairytale expansion than the University Centre in Svalbard (UNIS). Probably nobody imagined, back at the beginning in 1993, that anything like this was achievable at the North Pole. UNIS has beaten all records in proving itself an important player in its fields and is well recognised at home and also abroad. The interest from partner institutions is great and many interesting research projects are in train. The results are seen too, in the scientific production in 2004, when the numbers of articles in refereed scientific journals increased by 30 per cent.

Research at UNIS is highly diverse and great dedication is shown by researchers and supporting staff alike. In 2004 no less than 91 articles were published and many interesting discoveries were made. A team of biologists discovered mussels in Isfjorden, which may suggest a warmer climate in the water masses around Svalbard. Also, a team of geologists has discovered changes in siliceous algal communities and sediment geochemistry in several lakes on western Spitsbergen. These shifts are consistent with the predicted responses of lake ecosystems towards increased anthropogenic nitrogen deposition coupled with climate warming in recent decades. How these additive stressors may impact fragile arctic food chains will be a central issue in the future. One of our professor IIs, formerly a full-time staffer at UNIS, was rewarded in 2004 with the highly-prized "Up-and-Coming Young Researcher of the Year" (YFF).

Students continue to stream into UNIS, and 2004 was again a record year with 299 students doing 126 years of study. A total of 24 nationalities were represented with the proportion of Norwegians at about 40 per cent. The main body of students do come from Norway and the EU, however. This is a very gratifying development and our work to increase the interest among home students will be intensified in the years ahead. Following the instigation of the national quality reform, as it was known, throughout Norway, UNIS was faced with another stern test, to adjust to the new national structure.

During Easter 2004, three of our students and another friend were reported missing on a private expedition. Despite terrible weather, they succeeded in releasing an emergency homing beacon. In the ensuing days this incident received so much attention from the media that UNIS was under virtual siege by reporters and TV crews for several days and nights. This was a new experience for us and I want to take this opportunity to praise all the staff and students who were involved in those hectic days. The incident had a happy outcome, but the experiences learned will be taken onboard in our future safety training at UNIS.

The Student Welfare organisation in Tromsø and UNIS have always worked well together and in 2004 it was decided to build a new hall of residence for students. This was wonderful news and enables us to reach our goal of 150 student years by 2008. The dormitory will be finished by autumn 2005.

The year 2004 was a very tight time for the Institution economically due to the significant deficit in 2003. A total of four courses had to be cancelled, but by year's end the accounts were again almost 2.3 million kroner into the black.

Let me take this opportunity to thank all staff for their excellent efforts in the year now passed. Without our energetic staffers at all levels in the organisation UNIS would not be where we are today. It was my privilege to take the chair after Audhild Schanche in April, and I will extend my heartfelt thanks to her for the magnificent contribution she has made for UNIS. Taking the helm of an organisation that is already up and running is a highly pleasurable experience.

In the year ahead we must continue to shine a sharp focus on the quality of our research and education, and also begin reaping the rewards of the Svalbard Science Centre. The refurbishment of the old building and general heavy activity will present us with severe demands for flexibility and our capacity to devise solutions that will keep the wheels turning. UNIS is also all set to play a key role in the International Polar Year scheduled for 2007 and 2008.

## Et år med store utfordringer

Få institusjoner innen forskning og høyere utdanning i Norge, eller noe annet sted for den saks skyld, kan vise til en mer eventyrlig utvikling enn Universitetssenteret på Svalbard (UNIS). Ingen hadde vel trodd tilbake ved oppstarten i 1993 at noe slikt var mulig å få til på Nordpolen. UNIS har i rekordfart markert seg som en viktig aktør innenfor sine fagområder og er godt kjent både nasjonalt og internasjonalt. Pågangen fra samarbeidende institusjoner er stor og mange interessante forskningsprosjekter er på gang. Dette vises også i den vitenskapelige produksjonen for 2004 hvor antall artikler i vitenskapelige tidsskrift med referee-ordning økte med 30 %.

Forskningen ved UNIS er svært mangfoldig og det legges ned en stor innsats fra forskere og støtteapparatet. I 2004 ble det publisert i alt 91 artikler og mange interessante funn ble gjort. Et team av biologer oppdaget blåskjell i

Isfjorden som kan indikere et varmere klima i vannmassene rundt Svalbard. Videre har et team av geologer oppdaget endringer i sammensetningen av kiselalger og geokjemisk sammensetning i sedimenter i flere innsjøer på Vest-Spitsbergen. Slike endringer er i overensstemmelse med hvordan økosystemer i innsjøer reagerer på endringer i antropogent nitrogenopptak kombinert med klimaendringer. Hvordan dette kan påvirke den skjøre arktiske næringskjeden vil være en sentral problemstilling fremover. En av våre professor-II, som tidligere har vært ansatt i full stilling ved UNIS, fikk i 2004 en svært viktig status – "Yngere fremragende forsker - YFF".

Studentene fortsetter å strømme til UNIS og 2004 var nok et rekordår med 299 studenter tilsvarende 126 årsverk. I alt 24 nasjoner var representert og andelen av norske studenter var ca.40 %. Hovedvekten av studenter stammer imidlertid fra

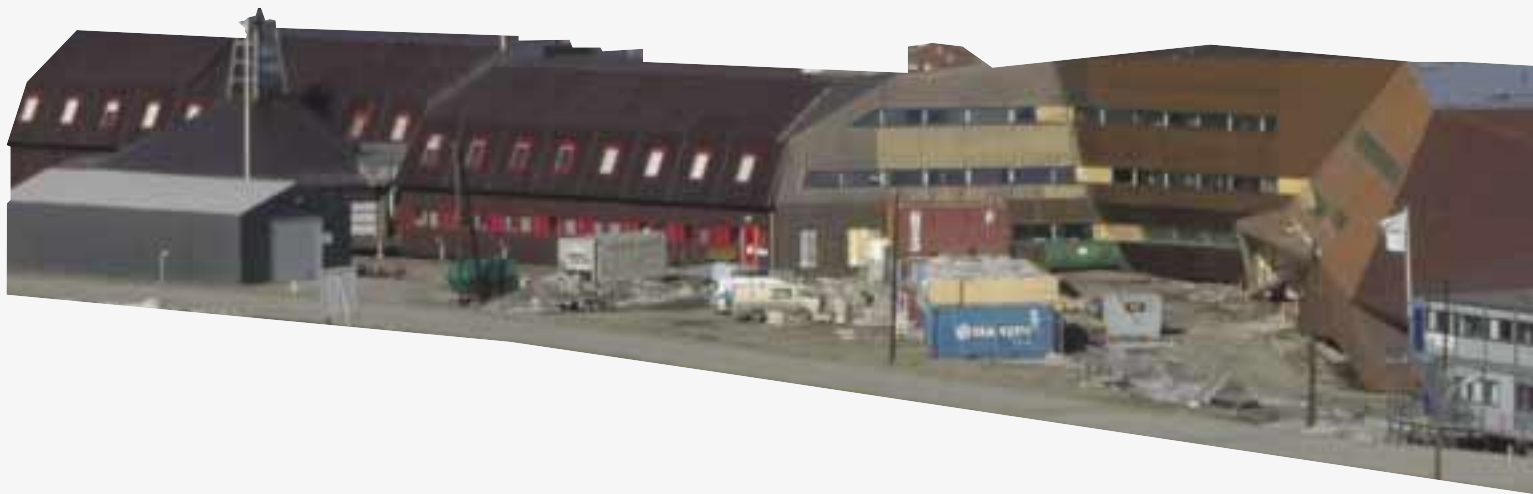

Most of the construction work on the Science Centre was finished during the summer of 2004. Photo: Ketil Rønning

Norge og land innen EU. Dette er en svært gledelig utvikling og vårt arbeid med å øke den norske andelen skal forsterkes i årene som kommer. Etter at den såkalte kvalitetsreformen ble gjennomført nasjonalt har dette satt UNIS overfor nye utfordringer med tilpassing til ny nasjonal struktur.

Påsken 2004 ble tre UNIS studenter meldt savnet etter en privat tur og sammen med en kamerat utløste de en nødpeilesender i et forrykende uvær. I dagene som fulgte fikk denne saken mye oppmerksomhet i media og UNIS ble nærmest beleiret i flere døgn av journalister og TV-team. Dette var en ny erfaring for oss og jeg vil benytte anledningen til å rose alle ansatte og studenter som var involvert i disse hektiske dagene. Hendelsen fikk et lykkelig utfall, men erfaringene vil vi dra nytte av i den videre sikkerhetsopplæringen ved UNIS.

Studentsamskipnaden i Tromsø og UNIS har alltid hatt et nært samarbeid og i 2004 ble det besluttet å bygge et nytt hybelbygg for studentene. Dette er svært gledelig og gjør oss i stand til å nå målet med 150 studentårsverk i 2008. Bygningen skal stå ferdig høsten 2005.

I 2004 ble et meget stramt år økonomisk for institusjonen på grunn av et stort underskudd i 2003. I alt fire kurs ble avlyst, men ved årets utgang viste regnskapet et overskudd på nærmere 2,3 mill.kr.

Jeg vil med dette rette en takk til alle ansatte for en stor arbeidsinnsats i året som gikk. Uten energiske ansatte på alle nivå i organisasjonen kunne UNIS ikke vært der vi er i dag. Jeg overtok stolen etter Audhild Skancke i april og vil rette en stor takk til henne for det betydelige arbeidet hun har utrettet for UNIS. Det å overta en organisasjon som er på skinner er veldig bekvemt.

I året som kommer vil vi fortsatt ha stort fokus på kvalitet i forskning og utdanning samt på å ta Svalbard Forskningspark i bruk. Ombygging i "gammelbygget" og stor aktivitet generelt vil stille store krav til fleksibilitet og evne til å finne løsninger for å få hjulene til å gå rundt. UNIS vil også markere seg som en viktig aktør i det internasjonale polaråret som skal gå av stabelen i 2007 og 2008.

April 2005,

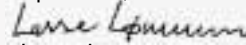

Lasse Lønnum

Direktør

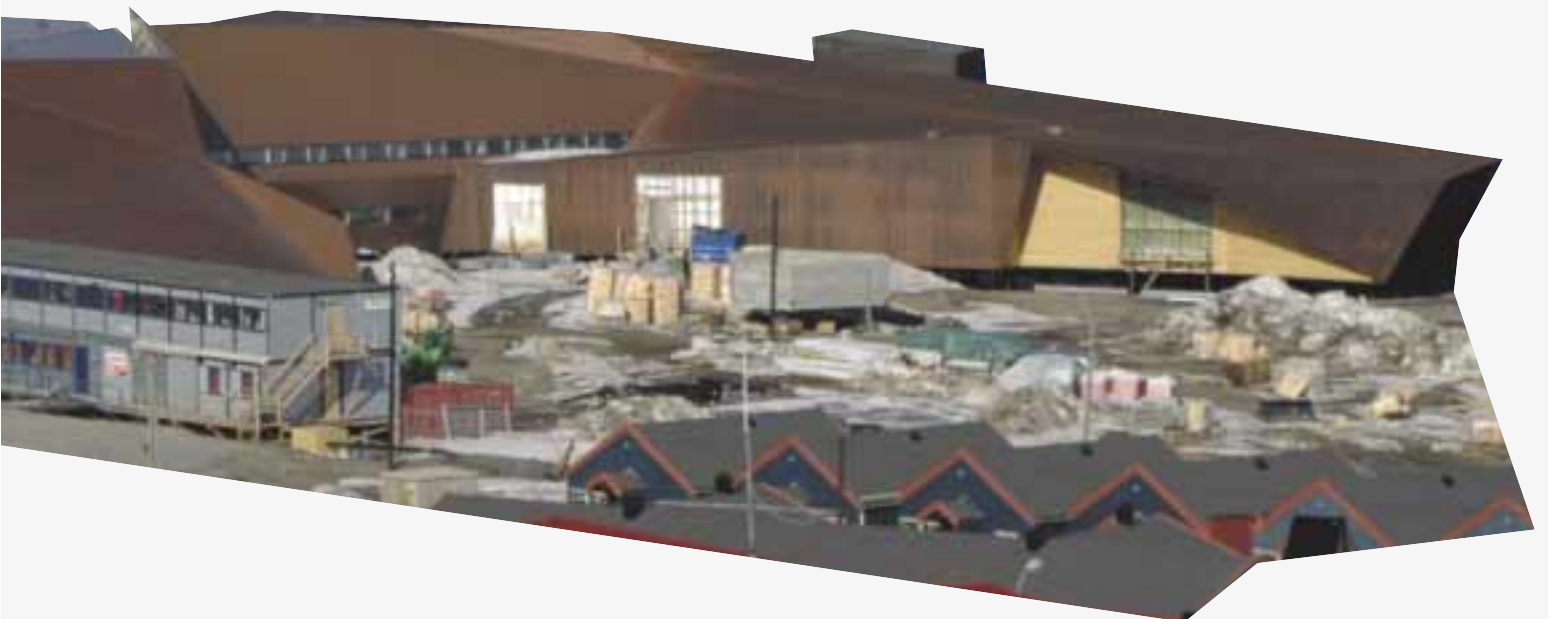

# Report of the Board of Directors

The University Centre in Svalbard (UNIS) was reorganised as a public limited corporation on 29th November 2002. It replaced the former University Courses on Svalbard, also known as UNIS, which was a foundation established by the Norwegian University of Science and Technology in Trondheim, the University of Bergen, the University of Oslo, and the University of Tromsø, in 1994.

The objects of the present corporation are to provide study alternatives and engage in research based on the unique geographical location of Svalbard in the high Arctic, and the special advantages this confers by making use of the environment as a laboratory and observation arena, and for the collection and analysis of data. The educational offerings at university level function as a supplement to the tuition given at Norway's mainland universities. Courses are part of the regular study path leading to the various degrees of bachelor, masters, and PhD.

The range of courses offered in 2004 matched the curriculum in 2003 although the number of students has never been higher. Research activities were also high, as is reflected in the increased level of external grants, initiations of and participation in projects, and the numbers of scientific papers.

## DEVELOPMENT OF STUDIES PROGRAMME

The studies offered at UNIS are international in profile and all tuition takes place in English.

UNIS offers four lines of study: Arctic Biology, Arctic Geology, Arctic Geophysics, and Arctic Technology. In 2004 the range of studies in the four lines was consolidated. Tuition was offered in 39 subjects, including a course on the History of Svalbard. Twenty courses were at masters and doctoral level.

Students at UNIS achieve good results and there is a less than 1 per cent failure rate in the degree awards. Semester students averaged 32.5 credits with a failure rate of roughly

1 per cent. Until 2008 UNIS intends to develop activities with a special focus on masters and doctorates. At the same time it is important to maintain the quality of offerings at the ordinary degree level.

UNIS is an active partner in The University of the Arctic (Uarctic) and is responsible for coordinating the Field School activity.

## STUDENT BODY

There were 299 students either taking tuition in the year or working on their masters or doctoral degrees. This is equivalent to 126 student years worked. The number breaks down to 62 student years on a lower degree, 32 on a masters and doctoral courses, and 32 on masters and doctoral theses.

UNIS boasts a high complement of international students and this student category accounted for 62 per cent of the student body. About half the international students came from the Scandinavian countries with 24 nationalities being represented all told. The proportion of female students in the Institution overall was roughly 46 per cent in 2004.

## RESEARCH ACTIVITY

In 2004 UNIS had 47 students doing work on their masters thesis in association with UNIS and 31 students registered at UNIS doing doctoral theses. The programmes are a partnership with another university in Norway or abroad. The students are appointed a tutor at UNIS and also have their own tutor at the home university.

During 2004 there were 17 masters degree students doing their thesis at UNIS, and two doctoral candidates were graduated. Development and continuation of research partnerships with Norwegian universities and other Norwegian and international research institutes is one of our priorities at UNIS. In 2004 UNIS staff authored or coauthored 91 publications under referee schemes, representing an increase of 30 per cent over 2004.

The Directors are highly satisfied with this positive development. Several of our research fellows are central figures in EU projects and several projects are funded, or partially funded, by the Norwegian Research Council. In 2004 three new adjunct professor positions were provided in conjunction with the Norwegian Polar Research Institute.

## OTHER ACTIVITIES

The Directors consider it vital to continue to work actively to promote UNIS. In January-February the so-called "Svalbard Seminar" was held in conjunction with the Norwegian Polar Research Institute and the Governor of Svalbard. Patronage was high, as always. UNIS draws many technical conferences and seminars and in 2004 nine such gatherings were held, four with international participation, including a NATO seminar involving 60 delegates and 11 ministers of education from the European Union. Many other presentations were also given for visiting groups from Norway and abroad.

One means of communicating our research results is via a webbased publication series. In order to ensure optimal promotion of research in the new Science Centre, UNIS is providing planning input for the new exhibition at the museum.

## ORGANISATION

UNIS is organised into four academic departments, a technical department, and an administrative department. The department heads and the Managing Director together make up the Executive Committee. The academic committees for each line of study meet with their representatives from the universities once a year and act as the consultative body for the departments.

## STAFF DETAILS

As of 31st December 2004 the Institute retained an scientific staff of 15 persons in full-time positions plus 18 professor IIs and research assistant IIs. The technical staff of nine and administrative staff of ten made up the rest. UNIS also has six externally funded positions.

The Directors have noted that the proportion of women in these associate positions is lamentably low, a fact that

replicates the state of the employment market ten years ago. The Directors intend to address this problem in the future. Despite this aberration however, UNIS generally features a high proportion of women in the bachelor and masters courses, and indeed among scholarship holders.

The breakdown by gender is as follows:

	Women	Men	Total	Working years
Administration	6	4	10	8.5
Technical department	2	7	9	9
Scientific staff	3	12	15	15
Associate positions	1	17	18	3.6
Externally funded	5	1	6	6

## UNIS BUILDING, ACCOMMODATION, STUDENT ROOMS

The UNIS building was completed in 1995 and contains laboratories, classrooms, a large auditorium, library, canteen, 30 offices and reading alcoves for 100 students. For many years there has been a great shortage of space in the laboratories and staff offices, and for visiting lecturers, visiting research scholars and our scholarship holders. This situation will persist until UNIS can move into the new Science Centre in November 2005.

At year's end 2004 UNIS organised 29 family residences and ten apartments for staff. With the increase in research activity the Directors see an obvious need to allocate funds for residential investment.

The Student Welfare organisation in Tromsø (SiTø) is responsible for the rooms that UNIS students use and has renovated four old miners' dormitories in Nybyen, bringing the total now to 120 rooms. SiTø has long been planning a new block of student rooms in Nybyen and when this project materialises the total accommodation available to students will be 144 rooms.

It is absolutely vital for UNIS's activities that students are accommodated with satisfactory living conditions. The Directors are therefore determined to continue the good cooperation we have always enjoyed SiTø.

## FINANCES AND FUNDING

The funds for operation and investments available to UNIS are allocated through the Ministry of Education and Research's budget. In 2004 the grant totalled 44,649,000 Norwegian kroner, of which kr 43,562,904 was spent on operations. The 2004 accounts show that 42.7 per cent of goods and services were purchased locally. The operating profit reported in the accounts for 2004 was kr 725,633. After financial adjustments and the extraordinary items the accounts show a profit of kr 2,278,953. The institute's total assets at 31st December 2004 were kr 16,522,327,

of which kr 7,932,954 constitute the buildings, and kr 2,621,533 is share capital and other equity. In 2004 the two successive Managing Directors received kr 479,542 and 238,074, respectively. Emoluments to the Board in 2004 amounted to kr 35,000 to the Chairman and kr 20,000 to the other directors.

## GOING CONCERN

The Annual Report and Accounts are presented on the assumption of a going concern. This assumption is based on the prognosticated results for 2005 and the long-range strategic plans that UNIS has for 2001-2010.





## WORKING ENVIRONMENT AND STAFF

Sickness absence in the year was 0.96 per cent. The Institute has a contract with Longyearbyen City Hospital for corporate health services and will be applying for status as an IA corporation. There have been no reports of injuries or serious work incidents or accidents in 2004 resulting in serious material damage or personal injury.

The UNIS building, put up in 1995, now has very stringent standards for the indoor environment. Modern building methods, careful choice of materials and good technical solutions all result in an excellent internal climate.



UNIS is not aware of any pollution caused to the external environment by Institute operations.

In April three UNIS students were the targets of a rescue operation that was widely reported in the media. The Directors wish to commend Institute personnel for the excellent manner in which the situation was handled. The Directors will also express their satisfaction that the incident ended happily, and are pleased that the lessons learned will be incorporated into future safety training for students and staff.

## BOARD ACTIVITIES

In 2004 the UNIS Board held four meetings, two of them in Longyearbyen. Some 80 cases were dealt with. Key issues included the Annual Plan, appointment of the incoming Director, continual review of the plans for the new building, and the budget.

## GENERAL MEETING

The General Meeting was held in Oslo on 3rd May 2004.

## THE ROAD FORWARD

The design plans for fitting out the UNIS areas in the Science Centre have been finalised. Work at the Institution will be coloured in coming years by the introduction of the Science Centre as a working establishment. The Directors have adopted a Development Plan for the period 2004-2008 entailing the consolidation and development of the Institution's activities, with a growth of 16 positions in all, and an increase in student numbers of 50 per cent.

In accordance with the Storting Resolution to expand activities at UNIS the Board will engage in active and constructive dialogue with the Ministry of Education and Research. The Directors will give priority to the plans for a new Aurora Station which will make it possible to sustain Norwegian activities in optical Northern Lights research.

From left: Rolf Langvatn, Lasse Lønnum, Kjell A. Sælen, Else Hegseth, Steinar Nordal, Annik Myhre, Frank Nilsen, Fredrikke J. Musæus, Kjell Mork, Simon Jessen Photo: Helen Flå

# Styrets beretning 2004

Universitetssenteret på Svalbard AS (UNIS) ble opprettet som statlig aksjeselskap den 29. november 2002. Selskapet avløste stiftelsen Universitetsstudiene på Svalbard (UNIS), som ble opprettet av Norges teknisk- naturvitenskapelige universitet, Universitetet i Bergen, Universitetet i Oslo og Universitetet i Tromsø i 1994.

Selskapets formål er å gi studietilbud og drive forskning med utgangspunkt i Svalbards geografiske plassering i et høyarktisk område, og de spesielle fortrinn dette gir gjennom bruk av naturen som laboratorium og arena for observasjoner og innsamling og analyse av data. Studietilbudet skal være på universitetsnivå og fremstå som et supplement til den undervisning som gis ved universitetene på fastlandet, og inngå i et ordinært studieløp som fører frem til eksamener og grader på bachelor-, master- og doktorgradsnivå.

Kursomfanget har i 2004 vært på samme nivå som foregående år, men antallet studenter var det høyeste noensinne. Forskningsaktiviteten har vært høy, noe som gjenspeiles i økte eksterne bevilgninger, initiering og deltakelse i prosjekter og antall vitenskapelige publikasjoner.

## UTVIKLING AV STUDIETILBUDET

Studietilbudet ved UNIS har en internasjonal profil, og all undervisning foregår på engelsk.

UNIS har fire studieretninger: Arktisk biologi, Arktisk geologi, Arktisk geofysikk og Arktisk teknologi. I 2004 ble studietilbudet innen de fire studieretningene konsolidert. Det ble gitt undervisning i totalt 39 emner, inkludert et kurstilbud i Svalbards historie. 20 av kursene er på hovedfags- og doktorgradsnivå. Studentene ved UNIS oppnår gode resultater og har mindre enn en prosent stryk til eksamen. Semesterstudentene tok i 2005 i gjennomsnitt 32,5 studiepoeng og strykprosenten var om lag 1 %. Frem mot 2008 ønsker UNIS å videreutvikle aktiviteten med hovedvekt på mastergrads- og doktorgradsnivå. Samtidig

er det viktig at kvaliteten på studietilbudet på lavere grad vedlikeholdes.

UNIS deltar aktivt i utviklingen av The University of the Arctic (Uarctic) og har ansvar for å koordinere aktiviteten "Field School".

## STUDENTTALL

Til sammen 299 studenter fulgte undervisning, eller arbeidet med mastergrads- og doktorgradsoppgaver i 2004. Dette tilsvarer en studentaktivitet på 126 studentårsverk. Av årsverkene var 62 på lavere grad, 32 på mastergrads- og doktorgradsemner og 32 i forbindelse med mastergrads- og doktorgradsoppgaver. Ved UNIS er det et stort innslag av utenlandske studenter, og denne studentgruppen utgjorde i alt 62 % av studentmassen. Omtrent halvparten av de utenlandske studentene kom fra Norden, og i alt 24 nasjoner var representert i 2004. Kvinneandelen blant studentene lå i 2004 rundt 46% for institusjonen som helhet.

## FORSKNINGSAKTIVITET

I 2004 var det 47 studenter som arbeidet med sin mastergradsoppgave i samarbeid med UNIS, og 31 doktorgradsstudenter var registrert ved UNIS. Dette skjer i samarbeid med et universitet i Norge eller i utlandet. Studentene får oppnevnt en veileder ved UNIS og har i tillegg en veileder ved sitt hjemmeuniversitet. I løpet av 2004 tok 17 mastergradsstudenter sin mastergradsoppgave ved UNIS, mens 2 doktorgradsstudenter ble uteksaminert. Utvikling og videreføring av forskningssamarbeidet med de norske universitetene og andre norske og utenlandske forskningsinstitusjoner er en prioritert oppgave. I 2004 var UNIS- ansatte medforfatter på 91 publikasjoner med refereordning, noe som innebærer en økning på 30 % i forhold til 2004. Styret er svært fornøyd med denne positive utviklingen. Flere forskere er sentrale i EU-prosjekter og flere prosjekter er finansiert/delfinansiert av Norges forskningsråd. Det ble i 2004 opprettet 3 professor-II/førsteamanuensis-II stillinger ved UNIS i samarbeid med Norsk Polarinstitutt.

## ANNEN VIRKSOMHET

Styret ser det som viktig at det fortsatt arbeides aktivt med formidling ved UNIS. I januar/februar ble det såkalte "Svalbardseminaret" arrangert i samarbeid med Norsk Polarinstitutt og Sysselemanden på Svalbard. Oppslutningen var som vanlig meget god. UNIS tiltrekker seg mange faglige konferanser og seminarer, og i 2004 ble det i alt avholdt 9 slike, derav fire med internasjonal deltakelse, blant annet et NATO-seminar med 60 deltager og 11 undervisningsministre fra EU. I tillegg ble det gitt en rekke presentasjoner for gjestende grupper fra inn- og utland.

Forskningsresultater formidles bl.a. ved en nettbasert publikasjonsserie. For å bidra til en god forskningsformidling i den kommende Forskningsparken deltar UNIS i planarbeid for den nye utstillingen ved museet.

## ORGANISERING

UNIS er organisert med fire fagavdelinger, en teknisk avdeling og en administrativ avdeling. Avdelingslederne utgjør sammen med direktøren institusjonens lederteam. Fagutvalgene for hver av de fire studieretningene med representasjon fra universitetene møtes en gang i året og skal fungere som rådgivende organ for avdelingene.

## STABEN

Pr. 31. desember 2004 utgjorde den vitenskapelige staben 15 personer på full tid, samt 18 med professor II/ førsteamanuensis II tilknytning. Det var en teknisk stab på 9 personer og en administrativ stab på 10 personer. I tillegg har UNIS 6 eksternt finansierte stillinger.

Styret ser at andelen av kvinner i II-stilling er spesielt lav. Dette gjenspeiler arbeidsmarkedet for 10 år siden, og styret ønsker å fokusere på dette i fremtiden. Styret vil likevel fremhev at UNIS har en høy kvinneandel på bachelor- og masternivå, og også blant stipendiater.

Fordelingen mellom kjønnene er som følger:

	Kvinner	Menn	Antall personer	Årsverk
Administrasjonen	6	4	10	8.5
Teknisk avdeling	2	7	9	9
Vitenskaplig stab	3	12	15	15
II-stillinger	1	17	18	3.6
Eksternt finansierte	5	1	6	6

## UNIS-BYGGET, BOLIGER OG STUDENTHYBLER

UNIS-bygget stod ferdig i 1995 og inneholder laboratorier, undervisningsrom, et stort auditorium, bibliotek, kantine, 30 kontorer samt lesesalsplasser for 100 studenter. Det har gjennom flere år vært stor knapphet på laboratorier, kontorer til ansatte, gjesteforelesere, gjesteforskere og stipendiater. Denne situasjonen vil vedvare frem til UNIS kan flytte inn i Forskningsparken i oktober 2005.

Ved utgangen av 2004 disponerte UNIS 29 familieboliger og 10 hybelleiligheter til sine ansatte. Med økende forskningsaktivitet ser styret det som viktig at det fortsatt bevilges midler til investeringer i boliger.

Studentsamskipnaden i Tromsø har ansvaret for hybler til UNIS-studenter og har pusset opp fire gamle gruvearbeiderbrakker i Nybyen slik at de i dag kan tilby til sammen 120 hybler. Studentsamskipnaden i Tromsø har lenge hatt planer om et nytt bygg for studenthybler i Nybyen. Når det nye bygget realiseres vil den samlede boligmassen for studentene utgjøre til sammen 144 hybler.

For UNIS' virksomhet er det helt avgjørende å kunne gi studentene tilfredstillende boforhold, og styret legger stor vekt på å videreføre det gode samarbeidet med Studentsamskipnaden i Tromsø.

## ØKONOMI

Midler til drift og investeringer for UNIS bevilges over budsjettet til Utdannings- og forskningsdepartementet. I 2004 var bevilgningen på totalt kr 44.649.000, hvorav kr 43.562.904 gikk til drift. Regnskapet for 2004 viser at 42,7 % av varer og tjenester kjøpes lokalt. Driftsresultatet på årsregnskapet for 2004 viser et driftsresultat på kr 725.633. Etter finansinntekter/finanskostnader samt ekstraordinære poster viser regnskapet et overskudd på 2.278.953.

Selskapets totalkapital pr 31.12.04 var på kr 16.522.327 hvorav kr 7.932.954 utgjør institusjonens bygningsmasse og kr 2.621.533 utgjøres av aksjekapital og annen egenkapital. I 2004 er lønn til direktørene utbetalt med henholdsvis kr 479.542 og 238.074 . Styrehonorar er i 2004 utbetalt med kr 35 000 til styrets leder og kr 20 000 til styrets øvrige medlemmer.

### FORTSATT DRIFT

Årsoppgjøret er avlagt under forutsetning om fortsatt drift. Til grunn for antagelsen ligger resultatprognoser for 2005 og UNIS langsiktige strategiske plan for 2001-2010.

### ARBEIDSMILJØ OG PERSONALE

Sykefraværet var i 2004 på 0,96 %. Institusjonen har avtale med Longyearbyen Sykehus om bedriftshelsetjeneste og har vedtatt å søke status som IA-bedrift. Det er ikke forekommet skader eller rapportert om alvorlige arbeidsuhell eller ulykker i 2004 som har resultert i store materielle skader eller personskader.

I UNIS bygget, som ble oppført i 1995, er det stilt store krav til innemiljøet. Moderne byggemetoder, materialvalg og tekniske løsninger gir et godt inneklima.

UNIS kjenner ikke til at selskapets drift forurenser det ytre miljø.

I april var tre UNIS-studenter innblandet i en leteaksjon som fikk stor oppmerksomhet i media. Styret vil gi honnør til de

ansatte som håndterte situasjonen på en svært god måte. Styret er glad for at det ble et lykkelig utfall på hendelsen, og at erfaringene tas med i det videre arbeidet i utvikling av sikkerhetsopplæringen for studenter og ansatte.

### STYRETS VIRKSOMHET

I 2004 har styret for UNIS avholdt 4 møter, hvorav 2 i Longyearbyen. Det er i alt behandlet 80 saker. Viktige saker som ble behandlet i 2004 var årsplan, tilsetting av ny direktør, løpende gjennomgang av planene for nybygget og budsjett.

### GENERALFORSAMLING

Generalforsamlingen ble avholdt i Oslo den 3. mai 2004.

### VEIEN VIDERE

Planene for innredning av UNIS's areal i Forskningsparken er ferdigutformet. Arbeidet ved institusjonen de nærmeste årene vil være preget av at Forskningsparken tas i bruk. Styret har vedtatt en utviklingsplan for perioden 2004-2008 som innebærer en konsolidering og videreutvikling av selskapets virksomhet med en vekst på i alt 16 stillinger og økning av studenttallet med 50 %. I henhold til Stortingets vedtak om en økning i aktiviteten ved UNIS vil styret ha en aktiv og konstruktiv dialog med Utdannings- og forskningsdepartementet. Styret vil prioritere høyt å få realisert planene for en ny Nordlysstasjon for å kunne beholde en norsk aktivitet innen optisk nordlysforskning.

  
Kjell A. Sælen  
leder

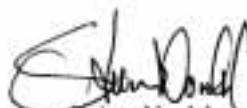
  
Steinar Nordal  
nestleder

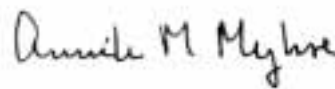
  
Annik Myhre

  
Else Nøst Hegseth

  
Kjell Mørk

  
Fredrikke Johansen Musæus

  
Frank Nilsen

  
Lasse Lønnum  
direktør

# Statistics / Statistikk

Publications etc at UNIS 1999–2004.  
Publikasjoner etc. ved UNIS 1999–2004.

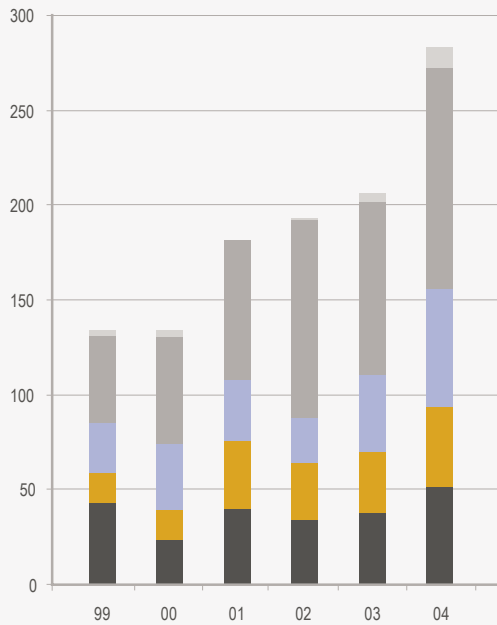

□ Books (all categories)      ■ Publications adjuncts  
 ■ Presentations (all categories)      ■ Publications scientific staff  
 ■ In press (all categories)

Workforce in man-labour years according to occupational category at UNIS 1998–2004.  
Årsverk ved UNIS 1998–2004 fordelt på stillingskategori.

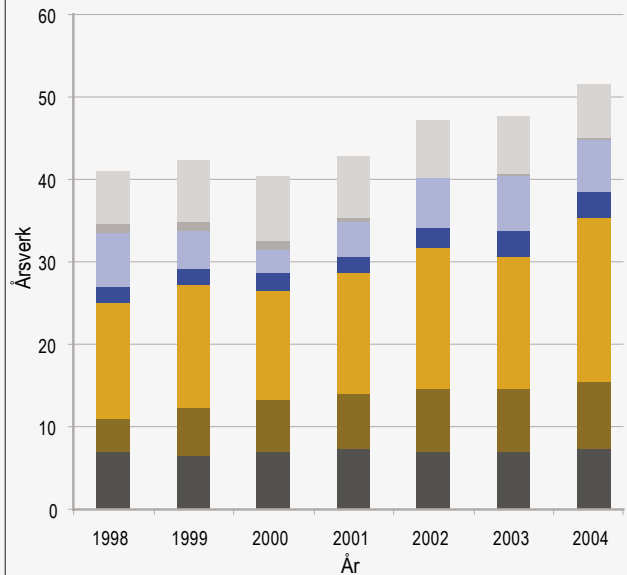

□ Adm      ■ Ekstern vit      ■ Årsverk gjesteforelesere  
 ■ Tekn      ■ Andre      ■ II-er still  
 ■ Forskestil

Number of students categorised as Norwegian Nordic and non-Nordic students 2000–2004.  
Totalt antall studenter ved UNIS 2000-2004 fordelt på norske, nordiske og ikke-nordiske.

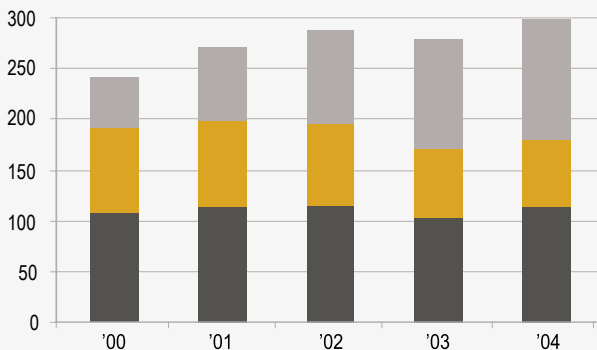

■ Non-Nordic students      □ Norwegian students  
 ■ Nordic students

Production in Student-labour years (1 year equals 60 ECTS credits) categorised on teaching levels.  
Produksjon av studentårsverk (ett årsverk = 60 studiepoeng) ved UNIS 2000-2004, fordelt på undervisningsnivå.

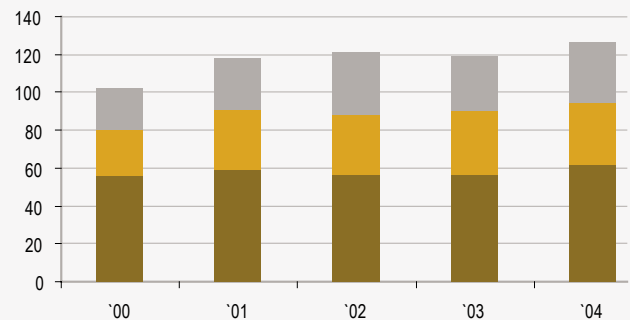

■ Graduate-courses      ■ Master/Ph.D. work  
 ■ Undergraduate-courses

# Resultatregnskap pr. 31.12.2004

	2004	2003
<b>Driftsinntekter og driftskostnader</b>		
Driftstilskudd fra KUF	43 562 904	40 083 550
Utsatt inntektsføring av tilskudd	135 100	-135 100
Eksterne prosjektinntekter	8 730 286	7 306 580
Øvrige inntekter	1 810 588	1 595 295
Brutto driftsinntekter	54 238 878	48 850 425
Eksterne prosjektkostnader	8 048 798	6 829 514
Netto driftsinntekter	46 190 080	42 020 810
Lønn og sosiale kostnader	24 150 303	21 551 616
Felt- og toktkostnader	6 980 050	6 978 650
Øvrige driftskostnader	14 334 094	15 390 628
Sum driftskostnader	45 464 447	43 920 894
<b>DRIFTSRESULTAT</b>	<b>725 633</b>	<b>-1 900 084</b>
<b>Finansinntekter og finanskostnader</b>		
Finansinntekter	71 333	267 128
Finanskostnader	98 012	78 490
Netto finansinntekter	-26 679	188 638
Ordinært resultat	698 953	-1 711 446
Ekstraordinære inntekter	1 580 000	
<b>ÅRSRESULTAT</b>	<b>2 278 953</b>	<b>-1 711 446</b>
<b>Disponeringer:</b>		
Til/ fra annen egenkapital	2 278 953	-1 711 446

# Balanse pr. 31.12.04

	2004	2003
<b>EIENDELER</b>		
<b>Anleggsmidler:</b>		
Bygninger	7 932 953	2 709 901
Andeler Svalbardhallen	1	1
Sum anleggsmidler	7 932 954	2 709 902
<b>Omløpsmidler</b>		
Varebeholdning	33 023	84 311
Debitorer	2 371 814	3 364 752
Andre kortsiktige fordringer	883 971	564 956
Betalingsmidler	5 300 565	8 250 222
Sum omløpsmidler	8 589 373	12 264 241
<b>SUM EIENDELER</b>	<b>16 522 327</b>	<b>14 974 143</b>
<b>GJELD OG EGENKAPITAL</b>		
Aksjekapital	100 000	100 000
Annen egenkapital	2 521 533	242 579
Sum egenkapital	2 621 533	342 579
<b>Avsetninger for forpliktelse:</b>		
Ubenyttet invester.tilsk.,utstyr		922 038
Ubenyttet invester.tilsk.bygg		3 400 000
Utsatt inntektsfør. tilskudd stipendiat	535 000	135 000
Sum avsetninger med forpliktelse	535 000	4 457 138
<b>LANGSIKTIG GJELD:</b>		
Boliglån SparebankEN Nord- Norge	5 250 000	
Sum langsiktig gjeld	5 250 000	
<b>Kortsiktig gjeld:</b>		
Leverandørgjeld	1 543 813	3 690 138
Skyldige offentlige trekk og avgifter	2 016 594	1 707 885
Annen kortsiktig gjeld	4 555 387	4 776 403
Sum kortsiktig gjeld	8 115 794	10 174 427
<b>SUM GJELD OG EGENKAPITAL</b>	<b>16 522 327</b>	<b>14 974 143</b>



Blue mussel  
discovered at  
Sagaskjæret in  
August 2004.



# Arctic Biology

The Department of Arctic Biology provides a full one-year curriculum of undergraduate course offerings as well as an extensive course calendar for graduate studies in addition to performing research in Arctic biology and ecology. The strategic plan of the department is to build up two active research groups, one in terrestrial and one in marine ecology. Each group has two full-time staff members currently in addition to five adjunct professors three of which are marine oriented and two terrestrial (2004).

In this year's annual report we have chosen to present one of the ongoing research projects run by the marine research group.

## OCEAN TEMPERATURE OSCILLATIONS CAUSES THE REAPPEARANCE OF BLUE MUSSELS IN SVALBARD AFTER 1,000 YEARS OF ABSENCE

By: Jørgen Berge and Geir Johnsen

### BACKGROUND

During two UNIS-expeditions in August and September 2004, a small population of blue mussels (*Mytilus edulis* L.) were discovered close to the rocky islet Sagaskjæret at the mouth of Isfjorden. This is the first recorded observation of a viable population of blue mussels in Svalbard since the Viking Age. Analyses of available data indicate that the reappearance of this species is closely connected to a recent increase in sea surface temperatures in the Svalbard sector of the Arctic.

### BLUE MUSSELS IN SVALBARD DURING THE HOLOCENE

During warm intervals of the Holocene, blue mussels have been common and numerous along the coast of Svalbard. Today, we find evidence of their previous distribution pattern in elevated beach beds such as one recently found in the fan delta in Adventfjorden: deposits of 3-5000 years old blue mussel shells were in abundance in the sediments in the Hiorthfjellet fan delta. Similarly, at Kapp Linné, a locality close to Sagaskjæret, remains of Holocene blue mussel are

common that have been found to be approximately 7,200 years BP.

### RECENT SPREADING OF BLUE MUSSELS

Our data indicate that most of the current mussel population found in Isfjorden settled at Sagaskjæret as spats in 2002, and that larvae were transported by the West Spitsbergen Current northwards from the Norwegian coast up to Svalbard the same year. This extension of the blue mussel's distribution was made possible by an unusually high northward flowing mass-transport of warm Atlantic water in addition to elevated sea surface temperatures in 2002. Remotely sensed data suggest that the temperatures in the surface layer in 2002 were 3 to 4 degrees (C) higher than normal (e.g. in 2004). In addition, oceanographic measurements in Isfjorden suggest that unusually large amounts of warm Atlantic water (transported northwards by the West Spitsbergen Current) penetrated Isfjorden in 2002. Transport of mussel larvae by way of ballast water is considered an unlikely route for the arrival of these mussels because all ships coming to Svalbard fill up ballast water off-shore, hence reducing the probability of transporting blue mussel larvae. Thus, three factors that occurred during the autumn of 2002 are probably those that provided the opportunity for larvae to reach Svalbard:

1. Increased northward transport of Atlantic Water by the northern branches of the Gulf Stream System. The estimated transport time from Vesterålen to Svalbard is around 35 days, which matches the longevity of blue mussel larvae.
2. Increased influx of Atlantic Water into Isfjorden.
3. Increased sea surface temperatures on the west coast of Svalbard providing acceptable conditions for blue mussel growth.

### FUTURE RESEARCH ON BLUE MUSSELS IN SVALBARD

During 2005 an underwater time-series station will be set up at Sagaskjæret which will allow us to measure both the physical key-environment variables (temperature, salinity,

currents, light climate etc) and monitor the blue mussel population. Also, the new lab facilities that will become available in the Science Centre will permit experimental work on survival and growth related to water temperatures to be conducted.

### THE MARINE BIOLOGY RESEARCH GROUP AT UNIS AND THE INTERNATIONAL POLAR YEAR (IPY)

By Ketil Eiane

The marine research group at UNIS aims at contributing to IPY through participation in several projects. Firstly, we take part in the ARCTOS network, which is based on an agreement between The Norwegian College of Fishery Science (NCFS), The Norwegian Polar Institute (NPI), Akvaplan-niva (APN), The University Centre in Svalbard (UNIS) and The University of Tromsø (UoT) (Department of Geology) to coordinate parts of their marine ecological activities. The intention for establishing the ARCTOS network is to increase the visibility of the marine ecological research being carried out in northern Norway and on

Svalbard, and through our joint efforts to increase impacts of our scientific efforts during IPY and beyond. ARCTOS will have a suite of activities, among those annual scientific plenum meetings, symposia on timely topics in Arctic marine ecosystem studies, and the ARCTOS scientific trainee school (established at UoT).

Secondary, members of the research group has participated in the initiation of the IPY project Marine Mammal Exploration of the Oceans - Pole to Pole (MEOP). This international initiative is based on our low level of knowledge about the oceanic habitat requirements of marine mammals, especially those of the large, highly mobile pelagic seals and whales that occupy Polar Regions. MEOP will deploy novel but field-proven satellite-linked animal-borne CTD-tags that will provide accurate data on the location of tagged animals, their detailed dive patterns and the temperature and salinity profiles of the water columns they utilize. By providing oceanographic-quality environmental data directly from the animals, we can explicitly link physical oceanographic conditions to the animal's behavior,

A 7200 year old blue mussel found by Hanne Christiansen at Kapp Linné. Photo: Frank Nilsen



overcoming the problems of time and scale inherent in using more conventionally derived ocean information, while reducing logistics costs and requirements (e.g. boat-time). Such *in-situ* data will allow precise identification of the water masses visited by the animals and quantification of their characteristics. At the same time, they will create unique oceanographic data sets, which can enrich existing ocean data archives.

## ACIA AND BIOLOGICAL RESEARCH AT UNIS

By Ingibjörg Jonsdóttir

The recent comprehensive assessment of climate change in the Arctic and its consequences (Arctic Climate Impact Assessment, ACIA, <http://www.amap.no/acia/index.html>), places UNIS into a renewed international focus. The key findings of the ACIA report point to the need for a stronger emphasis on research and education in potential climate impacts on biodiversity, species distribution and adaptations in both marine and terrestrial environments. On land, arctic vegetation zones are expected to shift northwards with wide-ranging consequences for ecosystems and wildlife. Reduction of sea ice is expected to alter substantially the structure and function of marine ecosystems. The Department of Biology at UNIS is well prepared to meet this challenge. Most ongoing research projects already focus on effects of changing climate on individual organisms, trophic interactions or ecosystem function. The Svalbard Archipelago with its variable landscape and diverse fjord systems provides ideal opportunities for such studies. Within short distances, highly variable conditions are encountered in the sea and on land that provide an opportunity for comparative work. The new Science Centre will improve opportunities for experimental evaluations of processes behind natural patterns as well as studies the explore to what extent these patterns reflect conditions in a changing climate.

## GRADUATES 2004:

### Dr. Students/ PhD

Piotr Kuklinski: Ecology of Bryozoa in Svalbard waters.

Matthias Zielke: Diversity and nitrogen fixation of cyanobacterial communities in terrestrial arctic ecosystems.

### Cand. Scient/Master students

Gry Bendiktson: Development of digital photography as a means to estimate species composition and species cover in tundra vegetation.

Arjen Breur: Dynamics of overwintering zooplankton in an Arctic fjord.

Helena Grev: Effects of grazing and warming treatments on growth commencement and above production in *Alopecurus borealis*.

Tore Kristian Leren: Hatch asynchrony: Consequences and possible causes in a population of snow bunting at Svalbard.

Bernt Rydland Olsen: Population structure of *Laminaria Digitata* (Hudson) J.V. Lamouranx from three different areas in the Northeast Atlantic ocean.



Geology students searching  
for active ice-wedges in  
Adventdalen in March 2004

Photo:Hanne Christiansen

# Arctic Geology

By **HANNE H. CHRISTIANSEN**

The Department has four main teaching and research areas: Pre-Quaternary Geology, Quaternary Geology, Marine Geology and Physical Geography. The research vision of the Department focuses on Svalbard, its fjords and adjacent shelf that offer an excellent opportunity to study a wide range of landforms, processes and sediments related to the development and infill of sedimentary basins. As an area of terrestrial outcrop on the Barents Shelf, Svalbard provides excellent access to a vast range of basin settings, from the low-latitude infill of the Devonian basins, to the present glacial and periglacial erosion and infill of valleys and fjords.

In 2004 the Department offered 13 courses; five at 200-level and eight at 300-level. The 200-level courses together make up the one-year 65 ECTS study programme offered at undergraduate level. The eight 300-level courses, offered to master and doctoral students, had a total of 68 ECTS. In total 1444 ECTS were produced in Geology in 2004.

Our academic staff now consists of 4 full-time faculty and 3 adjunct professors. Additional to that we have 7 Ph.D. students. Professor Tine Rasmussen finished her position at UNIS in Marine Geology in the autumn 2004, and started at the Department of Geology, University of Tromsø, Norway. Associate Professor Tove Nielsen from the Danish and Greenlandic Survey, took over as the Marine Geologist in December 2004. As the new Quaternary geologist Associate Professor Alexander Wolfe, University of Alberta, Canada, started in July. Professor Gary Nichols, came from Royal Holloway University of London, and started in June as the Pre-Quaternary Geologist in our Department.

Adjunct Professor Olafur Ingolfsson, University of Iceland, finished his position in Quaternary Geology in the autumn. Adjunct Professor Ole Humlum, Physical Geography, and Adjunct Professor Arild Andresen, Pre-Quaternary Geology, both from the University of Oslo, were prolonged for three

years in the autumn. Two new Ph.D. students, Lene Kristensen and Charlotta Lüthje started their studies in the autumn. During 2004 we have taken up one new external Ph.D. student, Neil Ross from the University of Cardiff, U.K, who visited the department for 2 months in 2004, to attend a UNIS course and perform an intensive field campaign with georadar measurements of pingos in the Adventdalen area.

The Department in 2004 thus experienced quite large staff changes, and gained new professional competence. Guest lecturers, however, still remain an important resource for implementation of our extensive range of courses. They are also regularly partners in our ongoing scientific projects. The contact with guest lectures is of great value to our students, who this way get to know closely more examples of research conducted on Svalbard and elsewhere in the Arctic.

During 2004 staff at the Department of Geology was actively engaged in several research projects. A number of projects were continued from the previous years and several new projects were initiated. Some examples of ongoing research at the Department are shortly outlined below.

Charlotta Lüthje started in 2004 a Ph.D. study on sedimentology and stratigraphy of the coal-bearing Firkanten Formation, Palaeocene, Spitsbergen. Her Ph.D. study is funded by the Store Norske coal company in Svalbard. The productive coal-mining in the Central Basin in Longyearbyen and Svea areas exploits seams within sandstone and mudstone strata of Palaeocene age, but details of the depositional environment are largely unknown. This project aims to use core material, provided by the ongoing exploration programme of Store Norske, to carry out a basin-wide sedimentological and stratigraphic analysis of the Firkanten Formation. The result will be an integrated sequence-stratigraphic model useful as a predictive tool for coal exploration.

Lene Kristensen also started a Ph.D. study in 2004 on the relationships between climate, ground temperatures and



Discussions on Linnebreen 25 July 2004. Photo: Hanne Christiansen

processes in the active layer and permafrost on Svalbard. She is investigating the thermal offsets between the air, snow and ground temperatures for improved understanding of the effects of climate change on permafrost conditions and in particular on active layer thickness in different types of sediment and bedrock of Svalbard.

Within stratigraphy and sedimentary geology Gary Nichols is focussing his research on climatic and tectonic controls on sedimentation in basins, with several large-scale basin analysis projects from Thailand and Spain, and Tertiary and Upper Palaeozoic basins in Svalbard. Integrated studies include uplift histories of the sediment source areas, provenance studies and basin-wide facies distribution analysis to determine the tectonic-climatic controls on the stratigraphic development of clastic sedimentary basins. He has future plans for working on the stratigraphic record of wildfire, by analysing fossil charcoal in the Palaeocene of the Central basin, Spitsbergen, and looking for evidence of fires in early land vegetation from the Devonian of Spitsbergen.

Alexander Wolfe works on compiling a large circum-arctic perspective of recent environmental change, including several sites on Svalbard, with co-authors from five countries. He continued investigating the potential synergistic effects of climate change and nitrogen deposition in the biogeochemistry of arctic lakes, with

work in progress for Svalbard. This work, in collaboration with Olafur Ingolfsson and Ph.D. student Sofia Holmgren also in at the Department, explores why the lake record of the last century is truly exceptional in the context of the late Holocene. Other work concerns Andean palaeoclimate, last interglacial climate in the arctic, Eocene microfossils, spectral reflectance of sediments, and recent changes in alpine lakes.

In Physical Geography Hanne H. Christiansen is continuing periglacial research focused on process measurements of ice-wedge activity, snow cover and ground thermal relationships, active layer - permafrost dynamics and slope processes. In addition palaeoenvironmental reconstructions based on ice-wedges and loess deposits are being carried out in the Adventdalen area. In 2004 a cooperation project using four different methods for registration of ice-wedge activity was initiated with Prof. N. Matsuoka, University of Tsukuba, Japan. The intensive automatic and manual measurements of ice-wedge dynamics have given new data on ice-wedge growth that enable improved interpretation of the palaeoenvironmental signal from the ice veins of the ice-wedges.

Masters degree students at the Department in 2004 studied various issues including snow distribution in the landscape and its relation to the distribution of glaciers, permafrost, Little Ice Age glaciation in Van Keulenfjorden, glacier hydrology of Longyearbreen using isotope geochemistry and georadar investigations, isotope variations along Longyearbreen, geochemistry of mine waste in Bjørndalen, the thermohaline ocean circulation and its control on sedimentation in the sea and marine sedimentation in a sediment core from the Svalbard area.

In March 2004 we had a visit by the Executive Committee of the International Union of Geological Sciences, IUGS. The IUGS President gave a presentation at UNIS about the IUGS initiative Planet Earth 2005-2007 about Earth Sciences for Society. We presented the activities of our Department to the Executive Committee. In September we hosted a field workshop of the ESF network Permafrost and Climate in the 21<sup>st</sup> Century (PACE21) with 36 participants; the workshop consisted of 2 days of presentations and 3



Duststorm in Adventdalen 30 September 2004. Photo: Hanne Christiansen

days of visits to permafrost and periglacial research sites around Longyearbyen. At the 32 International Geological Congress (IGC) in 2004, Norway was elected the host country of the next IGC in 2008. The topic of this Congress will be the arctic, with several field tours planned for Svalbard. This event will occur during the International Polar Year 2007-2009, bringing a large focus on geology in the arctic. The International Permafrost Secretariat of the International Permafrost Association was hosted in 2004 in the Department.

#### GRADUATES 2004:

##### **Cand. Scient/Master students**

Åse Hjetland Bringedal: Stable oxygen isotopes in Longyearbreen, Svalbard.

Marit Carlsen: Lille Istids Maksimum i Van Keulenfjorden; deglasiasjonsdynamikk og sedimentasjon under tilbaketrekningen.

Anja Fleig: Snow distribution dynamics and ground thermal regimes.

Jonas Ellehaug Hansen: Influence of meteorological and topographic conditions on snow avalanches on central Spitsbergen, Svalbard.

Malte Michel Jochmann: The geology of the Ispallen-area with emphasis on the coal bearing Firkanten formation.

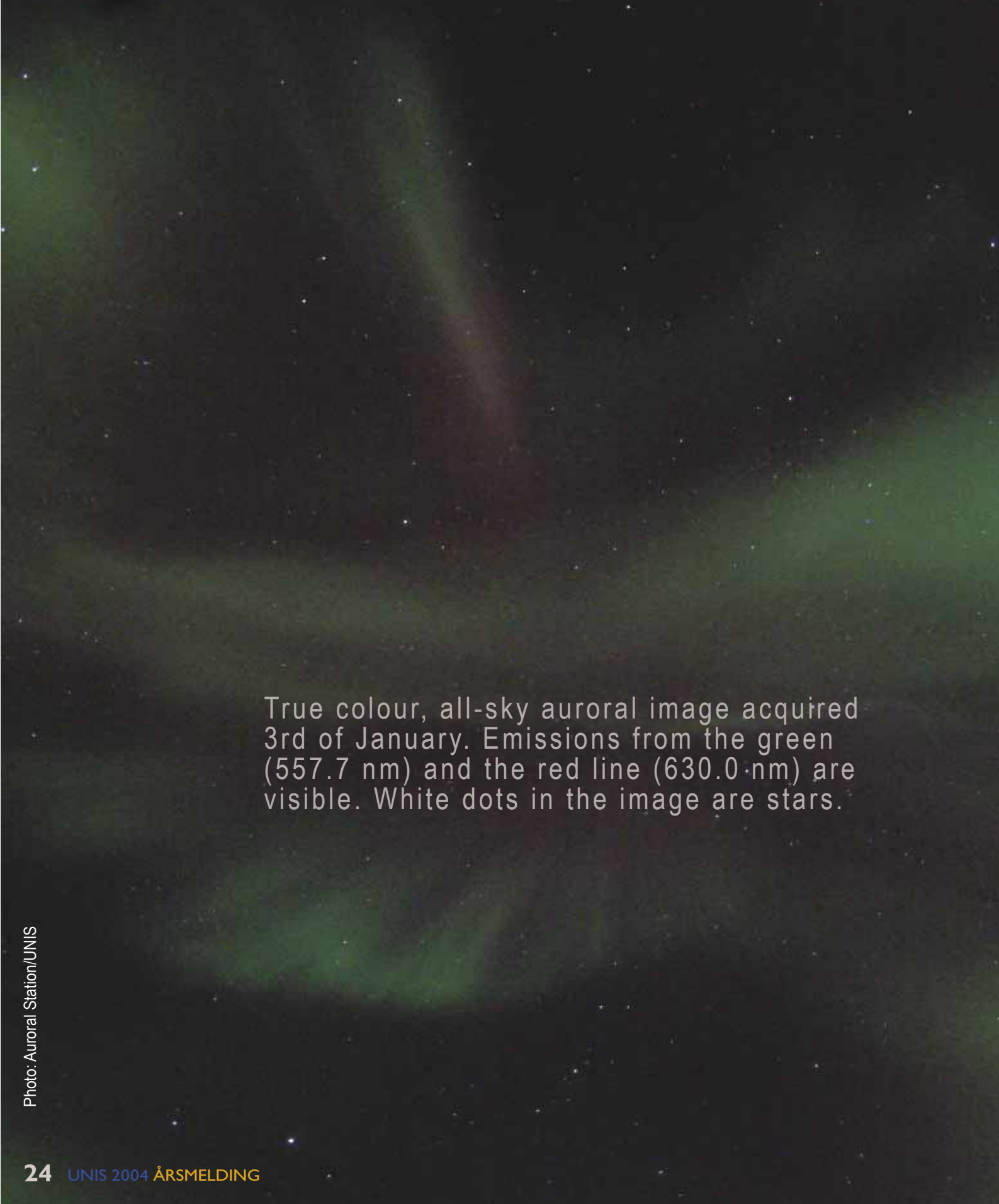

True colour, all-sky auroral image acquired 3rd of January. Emissions from the green (557.7 nm) and the red line (630.0 nm) are visible. White dots in the image are stars.



# Arctic Geophysics

By **FRED SIGERNES**

## INTRODUCTION

The Arctic Geophysics Department specialises in 4 fields of teaching and research: Oceanography, Meteorology, Middle- and Upper Atmosphere. Hence we cover the vertical column from below the sea surface out to near space. Our emphasis is on Polar geophysical phenomena with global implications, such as ocean currents, weather systems, and atmospheric processes related to environmental issues as well as the interaction between the solar wind and the Earth's magnetosphere.

4 full professorships and 5 adjunct professors cover the specialist fields. In 2004 the department had 6 doctoral fellows, 11 master's students and 1 Post Doc. 7 master's students completed their theses. Our Department has been accredited as a Madam Curie Training Site by the European Commission, and 2 of our PhD students were Madam Curie fellows.

## TEACHING

We currently offer 7 undergraduate and 5 postgraduate courses for students with background in physics. Students are introduced to processes and theories related to the Arctic environment. Fieldwork is an important element. Students get hands-on experience in instrument operation, data collection, and analysis of field data.

## RESEARCH

Our department supervises the daily operations of the Auroral Station in Adventdalen. The station has 25 instruments and engages 18 collaborating institutions from eight different countries. The activity at the station is high. In January 2004 the rocket SERSIO (Svalbard Eiscat Rocket Study of Ion Outflows) was launched from Ny-Ålesund. Data from the Auroral Station was ported via internet to UNIS where the launch decision was made. This is the first

time a sounding rocket is launched into space using the internet as transfer medium.

The Auroral Station suffers from increased light pollution, an outdated building, and limited space to accommodate new instrumentation. A building program for the new Auroral Station has been finalized by the Norwegian Directorate for Public Construction and Property. Funding for the construction has been appropriated.

Mesospheric temperature logs have been kept at the Auroral Station for almost 25 years, constituting one of the longest time series in the world. Quality assurance on the readings, as well as analysis of the data, is carried out at UNIS. Temperature records are important both in a global context, and for our understanding of the interaction between the upper and middle atmosphere.

A new generation of airborne spectral imagers has been developed at the department. The instruments detect spectral signatures of any target at high spectral and spatial resolution. The classification of clouds, snow, ice, melt water, and vegetation provide a few of the potential uses. Furthermore, the department has started a joint venture with the Technical University of Berlin, the Norwegian Space Agency and SVALSAT to use and operate the TUBSAT satellites. A S-band data downlink and a VHF command station are already in daily operation. The partners have also initiated a proposal to launch a micro satellite with hyper spectral capability: SVALBIRD.

A major project for the department is on estimating wind speed and wind stress on the Arctic Ocean from ERS-2 and ENVISAT satellites. Meteorological field campaigns were undertaken in September 2003 and September 2004, in conjunction with field courses in meteorology, to provide in situ data for comparison with data derived from microwave space borne satellite imagery.

We carry out studies of accretion and precipitation icing on structures located in complex terrain by collecting data

from two locations: Gaustadtoppen (1800 m), in south east Norway; and Brosviksåta (900 m), situated on the west coast of Norway. Instrumentation to monitor atmospheric turbulence and ice loads on cylindrical structures is installed. TV cameras monitor the icing process.

In 2004 we have contributed to the CLUE project (2003-2007), funded by the research council of Norway. In CLUE (Effects of Climate and Land Use change on nitrogen/carbon cycle) we measure the atmospheric nitrogen input to alpine regions in Norway by newly developed micrometeorological methods. Regional modeling by a chemical transport model supports the measurements and scenarios are made for

future climate effects based on the RegClim-project.

In 2004 the department has cooperated with the Norwegian Institute for Air Research (NILU) on monitoring and modeling of troposphere ozone deposition in Norway, as part of an international monitoring program funded by the United Nations. We have also been involved in measurements of mercury concentrations in Ny-Ålesund and evaluated the connection to local meteorology during the recently discovered so called mercury depletion events.

Our department takes part in studies of variability and exchanges in the North Atlantic, Fram Strait and the Arctic



Ocean. The oceanography group at UNIS focuses on how much heat the Atlantic Water core loses on its northward path along west Spitsbergen, and therefore also how this warm and saline water is guided into our fjord systems around Svalbard. Discovery of blue mussels in Isfjorden resulted in larger activity in the interdisciplinary ecology research community at UNIS, on the topic 'AW in Spitsbergen fjords', but also in a verification that our oceanographic models are doing a good job. Master students at UNIS are working on improving our understandings of physical oceanographic processes in Svalbard fjord systems.

Our Polar Ocean Climate Processes (ProClim) Post Doc in oceanography, Dr. Ragnheid Skogseth, have mainly focused on brine-enriched water resulting from sea-ice formation in coastal polynyas and along topographically influenced fronts and ice edges, and used Storfjorden as a laboratory for both observations and modeling.

Our Atmosphere/Ice/Ocean interaction studies project (NFR) continued in 2004. Van Mijenfjorden was used as our measuring sites and we performed field campaigns in March, April and June. Thanks to the Norwegian Coast Guard's icebreaking vessel KV Svalbard, we were able to conduct a major air-ice-ocean field program on melting sea ice in June 2004.

The collaborative project with Svalbard Samfunnsdrift (SSD) resulted in the UNIS report 'Sjøis-, vann og vindkrefter på nytt kaikonsept i Longyearbyen', and reflects the good dialog between the Geophysical Department at UNIS and the local community in Longyearbyen.

## GRADUATES 2004:

### Dr. Students/ PhD

Richo Belke: Cluster measurements at the Earth's bow shock, Space Physics. Madam Curie training site.

### Cand. Scient/Master students

Jon Bergh: Measured and modelled tidally driven mean circulation under ice cover in van Mijenfjorden.

Cai Dong: Mass balance of Nyaingen Tanglha glacier, Tibet, 1977 to 2001, derived by topographical maps and satellite images

Margit Elisabeth Dyrland: A multi-instrument analysis of postnoon auroral morphology and reconnection events during southeast IMF orientation.

Ivan Føre: Sea ice, snow cover and cloud detection using remote sensing.

Frank Gaardsted: The east Greenland current. Structure and variability.

Elen Monsen: Observation of plasma density patches by ESR.

Kristian Snekvik: CLUSTER Satellite Studies.

Johnny Grøneng Aase: Electron density measurements in the polar cusp.

*Previous page:* Oceanography and sea ice studies in Van Mijenfjorden June 2004 with principal investigators from UNIS, NP and The University of Washington. Due to the very good help from the Norwegian Coast Guard and the coast guard vessel KV Svalbard, we were able to do controlled experiments on melting sea ice. The collaborating scientist in the "Air-Ice-Ocean Interaction" AIO project focus on how rapid sea ice is really melting, which again will be used to improve today's climate models. Photo: Frank Nilsen

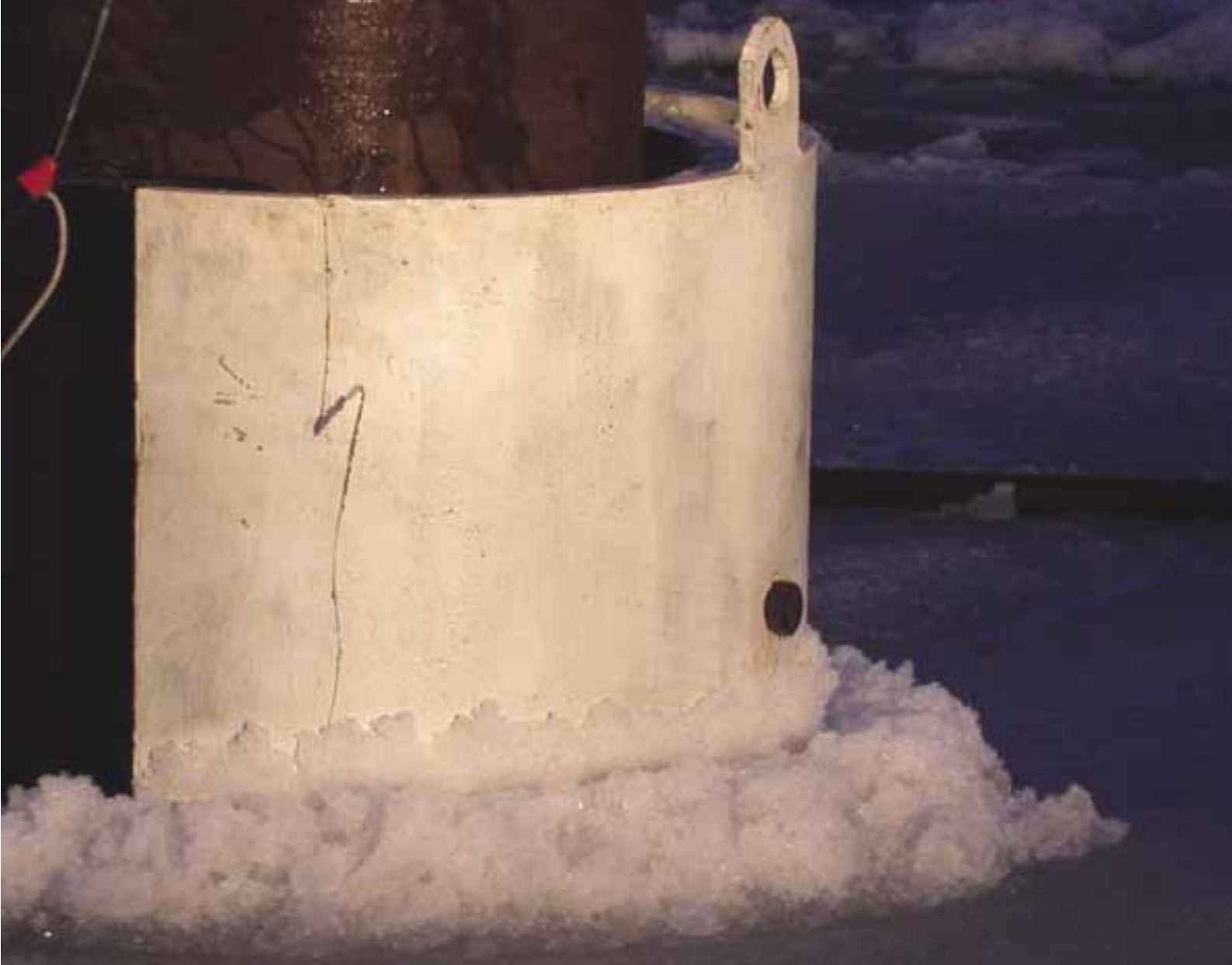

Measuring ice loads on a medium scale platform leg. From the test site in van Mijenfjorden between Svea and Kapp Amsterdam.

# Arctic Technology

By **LARS GRANDE**

The Arctic Technology Department offers education and research opportunities in Arctic Engineering and in Arctic Environmental Technology and Chemistry. Arctic Engineering concentrates on engineering problems to be tackled when settling in the Arctic environment: living and building on frozen ground that may be subject to landslides and avalanches (Geotechnics), Arctic offshore oil and gas exploitation (Ice Mechanics, Geotechnics), and potable water supply (Hydrology). Arctic Environmental Technology and Chemistry concentrates on current and potential pollution problems, environmental impacts and feasible remediation techniques in Arctic areas.

## ARCTIC ENGINEERING

The Department offers a full-time program in *Arctic Engineering*, offering level 200 courses in the spring (AT-205 and AT-208) and level 300 courses in the autumn (AT-323, AT-327 and AT-329). Students may combine their studies with courses from AETC and the other UNIS departments.

## ARCTIC ENVIRONMENTAL TECHNOLOGY AND CHEMISTRY

The Department also offers a full-time program in *Arctic Environmental Technology and Chemistry*, focusing on pollution in the Arctic. The courses making up the program can be heavily technology-biased, but we also encourage students to include offerings from other Departments, to form an interdisciplinary Arctic Environment program. Many students from the other Departments at UNIS also include our courses in Environmental Technology.

## RESEARCH

The technological challenges springing from increased human activity in the northern marine environments, as well as locally here on Svalbard, continue to be our main focus. The faculty staff continued to work on established research programs at UNIS and new studies were initiated.

The projects are detailed later in this section.

Key topics of interest within *Environmental Technology* include: The fate of oil spills in an Arctic environment and possible countermeasure techniques; levels and spreading of persistent organic pollutants (PCB pesticides in reindeer, Arctic fox, Polar cod, lake sediment and seaweed); and spreading and effects of pollution from local mining industry. Oil spills in an Arctic environment, for instance the waters around Svalbard, can be expected to behave significantly differently than oil spills in warmer waters, like the North Sea. The differences in spreading, evaporative loss, emulsification, dispersion and other factors add up to important modifications in operational oil spill contingency planning. There is a range of potential sources of oil spills in and around Svalbard, including fishing boats and freighters, tourist ships, and leakage or seepage from oil depots on land.

A new three-year program funded by the Norwegian Research Council, Statoil and Norsk Hydro focuses on oil spills in an Arctic marine environment. The purpose of this project is to investigate the weathering processes in marine oil spills under Arctic conditions. The focus is on the following processes: weathering of the bulk oil phase (evaporation, emulsification and dispersion), dissolution of water-soluble components, photo-oxidation and biodegradation processes. The PhD program by Liv-Guri Faksness is an integral part of this project.

The key topics within *Arctic Engineering* are permafrost and ice. We perform measurements and simulations of thermomechanical response in relation to onshore, coastal and offshore infrastructure. The main sites of our investigations are Longyearbyen, the Van Mijenfjord and Svea. We monitor ground temperature profiles down to 10 metres depth in open country, down the supporting piles at the Science Park, and in the waste tip in Adventsdalen. The development of the infrastructure and harbour facilities in Longyearbyen, as indeed in the Svea community, poses

important scientific and engineering tests for our staff and students. The ice cover in the Van Mijenfjord is stable throughout the season, allowing us to perform seasonal studies without risk of losing our equipment.

Several unique medium-scale experiments have been performed on the ice, close to the Svea community, over the last three years. In 2004 two medium-scale ice/vertical structure interaction experiments were performed as part of a PhD program by Per Olav Moslet. These experiments bring together a unique combination of real sea ice with measurements of load-determinants. The numerical analysis will continue in 2005. Ice conditions on the Van Mijenfjord were monitored, as usual, and in-situ ice stresses were monitored. The main focus here is on how environmental variables (meteorological and

oceanographic) determine ice conditions. In the Barents Sea we did our annual measurements and experiments on first-year sea ice ridges.

Our new SNSG-sponsored PhD student started his studies on techniques for utilising the local low-strength rock in exposed structures like erosion barriers, stone quays and road-fills. The project is a cooperative enterprise involving SNSG, SSD, Sintef and Bidim, the geotextile manufacturer. Tests will be performed in the harbour at Longyearbyen and in Sveasundet at Svea. Additionally the project will take a closer look at problems related to the possible transportation of coal from Ispallen to Cape Amsterdam, crossing the Credner Moraine and the Sveasundet channel.

Ground sampling on an ice-cored moraine near Svea. Photo: Fabrice Caline



**GRADUATES 2004:****Cand. Scient/Master students**

Anna Anderson: Analysis of polychlorinated biphenyls (PBCs) in arctic char from Svalbard using HRGC-ECD, with special emphasis on the correlation between physiological factors and contaminated load.

Jean-Charles Bordel: Estimation of ocean-ice heat flux from data in Van Mijen fjord (Analytical and numerical model).

Anders Laurentius Haaskjold Eide: Energy planning in Longyearbyen.

Lars Nesje Grimsmo: Wind and hydrogen Stand-alone power system.

K. Charlotta M. Rylander: Differentiation between anadromous and stationary arctic char.

Lisa Ström: Studying persistent organic pollution on Svalbard, focusing on PCB levels of Arctic *Salvelinus alpinus* from "Linnévatnet" and "Aresjøen".

Synnøve Yndestad: Mikrobiell diversitet i oljeforurensset og uberørt tundra på Svalbard.

Measurement of flame temperature and burning efficiency. Burning oil spills on-site could in some scenarios be an effective method to reduce the environmental impact from Arctic oil spills. The students receive hands-on experience with in-situ burning during the AT-207 Pollution in the Arctic field course. Photo: Per Johan Brandvik



# Student Body Annual Report

BY JORGEN BRAND

There are so many sides to student life on Svalbard that an attempt to fully describe all of them is futile. Students at UNIS come from all walks of life and many nationalities are in evidence. This creates a special blend of people, who share a fascination for the Arctic and all its facets. This fascination is certainly not limited to the lectures at UNIS. Students are fervent hikers, skiers and skidoo pilots. Many students even stay in summertime, when the studying is over, to work as a guide or undertake longer trips.

At the beginning of each semester a General Meeting of the student body is held, where all students elect the members of the Student Council. The Student Council exists to support the student body in Longyearbyen in all possible ways. In its basic form it consists of the President, Vice-president, Treasurer, Vice-treasurer, and the student representatives on the UNIS Board of Directors and on each of the four departmental boards. In addition ad hoc groups are responsible for the two cabins in Bjørndalen and Svea and our outdoor equipment, and ongoing activities like the weekly Friday gathering and Wednesday movie.

## FORMAL ENGAGEMENTS AND ACTIVITIES

The Council discusses topics of concern to the students, regarding student life in general, housing, academic issues and relations with the rest of the Longyearbyen community. The Council President represents the students at monthly executive team meetings, where the heads of departments, a representative of the staff, and the Director of UNIS discuss the daily running of the Institution. The students also nominate a Student Director on the UNIS Board of Directors, and are thus intimately involved in all the larger decisions concerning UNIS. The student departmental representatives attend faculty workgroups where they can ventilate their opinions in the departmental context. Considering these different representational paths in the structure of UNIS, and the relatively small size of the Institution, it has to be said that students have quite a big say in the decision process. As a whole we feel that the administration and faculties are very receptive to student input.

## INFORMAL ACTIVITIES

A huge list of activities are engaged in by students throughout the year. In almost any weather, you will find hardy students escaping from the urban sprawl of Longyearbyen to get physical with the Svalbard wilderness. To support these expeditions the Student



Even students in the arctic have to take a bath once in a while. Photo: Eirin Bjørkvoll

Council has two cabins – one in Bjørndalen, near Longyearbyen, and one in Svea – and a growing itinerary of survival equipment, ranging from tents and stoves to skidoo sleds. Regular student gatherings, like the weekly Friday session and the midweek movie on Wednesdays, are also organised by the Council.

All in all the student body is very active and visible in Longyearbyen. Students don't just study and mind their own business, they are an active bunch. And in addition to their own outdoor pursuits and frequent arrangements in the Sports Hall, they also make an energetic contribution to the social calendar in Longyearbyen. During Solstice Week and the various musical festivals, students devote a lot of energy to volunteer work. Students also hold the waterfun contest for swimmers of all ages, as well as the annually reoccurring "Take a Chance" contest in Solstice Week.

Yet, despite all these diversions, a word of caution is called for. Coming to Svalbard as a student has proven addictive. Many former students cannot stay away, thanks to the intimacy of UNIS, the astounding surroundings, the magical lighting effects, and the unforgettable excursions. In short, be warned: the Svalbard experience will alter you for life!



# Scientific publications 2004

## SCIENTIFIC PUBLICATIONS IN REVIEWED JOURNALS BY FULL-TIME FACULTY

- Balaguru, A. & Nichols, G. (2004). Tertiary stratigraphy and basin evolution, southern Sabah (Malaysian Borneo). *Journal of Asian Earth Sciences*. 23, 4, 537-554.
- Barnes, D.K.A. & Kuklinski, P. (2004). Scale-dependent variation in competitive ability among encrusting arctic species. *Marine Ecology-Progress Series*. 275, 21-32.
- Barnes, D.K.A. & Kuklinski, P. (2004). Variability of competition at scales of 10<sup>1</sup>, 10<sup>3</sup>, 10<sup>5</sup>, and 10<sup>6</sup> m : encrusting arctic community patterns. *Marine Biology*. 145, 2, 361-372. DOI: 10.1007/s00227-004-1320-z.
- Basedow, S.L., Eiane, K., Tverberg, V. & Spindler, M. (2004). Advection of zooplankton in an arctic fjord (Kongsfjorden, Svalbard). *Estuarine Coastal and Shelf Science*. 60, 1, 113-124.
- Behlke, R., Andre, M., Bale, S.D., Pickett, J.S., Cattell, C.A., Lucek, E.A. & Balogh, A. (2004). Solitary structures associated with short large-amplitude magnetic structures (SLAMS) upstream of the Earth's quasi-parallel bow shock. *Geophysical Research Letters*. 31, 16, L16805. DOI: 10.1029/2004GL019524.
- Berge, J. (2004). The subfamily Andaniopsinae (Crustacea : Amphipoda: Stegocephalidae) : description of one new species and redescription of *Steleuthera maremboca*. *Journal of Natural History*. 38, 11, 1385-1395.
- Berge, J. & Vader, W. (2004). Description of two new and unusual Stegocephalid species (Crustacea: Peracarida: Amphipoda: Stegocephalidae) from Heard Island and the East China Sea. *Transactions of the Royal Society of South Australia*. 128, 1, 1-11.
- Berge, J. & Vader, W. (2004). Two new Antarctic stegocephalid (Amphipoda: Stegocephalidae: Stegocephalinae) species, with implications for the phylogeny and classification of the two genera *Pseudo* and *Schellenbergia*. *Deep Sea Research Part II: Topical Studies in Oceanography*. 51, 14-16, 1709-1716.
- Berge, J., Vader, W. & Lockhart, S. (2004). A survey of amphipod associates of sea urchins, with description of new species in the genera *Lepidepcreella* (Lysianassoidea: lepidopcreellid group) and *Notopoma* (Photoidea: Ischyroceridae) from Antarctic cidarids. *Deep Sea Research Part II: Topical Studies in Oceanography*. 51, 14-16, 1717-1731.
- Bonenfant, C., Loe, L.E., Mysterud, A., Langvatn, R., Stenseth, N.C., Gaillard, J.M. & Klein, F. (2004). Multiple causes of sexual segregation in European red deer : enlightenments from varying breeding phenology at high and low latitude. *Proceedings of the Royal Society of London Series B-Biological Sciences*. 271, 1542, 883-892.
- Bråthen, K.A., Agrell, J., Berteaux, D. & Jónsdóttir, I.S. (2004). Intraclonal variation in defence substances and palatability : a study on *Carex* and lemmings. *Oikos*. 105, 3, 461-470.
- Callaghan, T.V., Björn, L.O., Chernov, Y., Chapin, T., Christensen, T.R., Huntley, B., Ims, R.A., Johansson, M., Jolly, D., Jonasson, S., Matveyeva, N., Panikov, N., Oechel, W., Shaver, G., Elster, J., Jónsdóttir, I.S., Laine, K., Taulavuori, K., Taulavuori, E. & Zöckler, C. (2004). Responses to projected changes in climate and UV-B at the species level. *Ambio*. 33, 7, 418-435.
- Callaghan, T.V., Johansson, M., Heal, O.W., Sællthun, N.R., Barkved, L.J., Bayfield, N., Brandt, O., Brooker, R., Christiansen, H.H., Forchhammer, M., Høye, T.T., Humlum, O., Jarvinen, A., Jonasson, C., Kohler, J., Magnusson, B., Meltofte, H., Mortensen, L., Neuvonen, S., Pearce, I., Rasch, M., Turner, L., Hasholt, B., Huhta, E., Leskinen, E., Nielsen, N. & Siikamaki, P. (2004). Environmental changes in the North Atlantic region : SCANNET as a collaborative approach for documenting, understanding and predicting changes. *Ambio Special Report*. Supplement 13, 39-50.
- Camus, L., Davies, P.E., Spicer, J.I. & Jones, M.B. (2004). Temperature-dependent physiological response of *Carcinus maenas* exposed to copper. *Marine Environmental Research*. 58, 2-5, 781-785.
- Camus, L. & Gulliksen, B. (2004). Total oxyradical scavenging capacity of the deep-sea amphipod *Eurythenes gryllus*. *Marine Environmental Research*. 58, 2-5, 615-618.
- Camus, L., Pampanin, D.M., Volpato, E., Delaney, E., Sanni, S. & Nasci, C. (2004). Total oxyradical scavenging capacity responses in *Mytilus galloprovincialis* transplanted into the Venice Lagoon (Italy) to measure the biological impact of anthropogenic activities. *Marine Pollution Bulletin*. 49, 9-10, 801-808.
- Christiansen, H.H. (2004). Meteorological control on interannual spatial and temporal variations in snow cover and ground thawing in two northeast Greenlandic circumpolar-active-layer-monitoring (CALM) sites. *Permafrost and Periglacial Processes*. 15, 2, 155-169. DOI: 10.1002/ppp.489.
- Christiansen, H.H. (2004). Windpolished boulders and bedrock in the Scottish Highlands : evidence and implications of late devensian wind activity. *Boreas*. 33, 1, 82-94.
- Cooper, E.J. (2004). Out of sight, out of mind : thermal acclimation of root

respiration in arctic *Ranunculus*. *Arctic, Antarctic, and Alpine Research*. 36, 3, 308-313.

**Cooper, E.J.**, Alsos, I.G., Hagen, D., Smith, F.M., Coulson, S.J. & Hodkinson, I.D. (2004). Plant recruitment in the high Arctic : seed bank and seedling emergence on Svalbard. *Journal of Vegetation Science*. 15, 1, 115-124.

Dahl-Jensen, T., Larsen, L.M., Pedersen, S.A.S., Pedersen, J., Jepsen, H.F., Pedersen, G.K., **Nielsen, T.**, Pedersen, A.K., von Platen-Hallermund, F. & Weng, W. (2004). Landslide and tsunami 21 November 2000 in Paatut, west Greenland. *Natural Hazards*. 31, 1, 277-287.

**Eiane, K.** & Ohman, M.D. (2004). Stage-specific mortality of *Calanus finmarchicus*, *Pseudocalanus elongatus* and *Oithona similis* on Fladen Ground, North Sea, during a spring bloom. *Marine Ecology-Progress Series*. 268, 183-193.

**Faksness, L.G.**, Grini, P.G. & Daling, P.S. (2004). Partitioning of semi-soluble organic compounds between the water phase and oil droplets in produced water. *Marine Pollution Bulletin*. 48, 7-8, 731-742.

Fer, I., **Skogseth, R.** & Haugan, P.M. (2004). Mixing of the Storfjorden overflow (Svalbard archipelago) inferred from density overturns. *Journal of Geophysical Research-Oceans*. 109, C1. DOI: 10.1029/2003JC001968.

Fosse, L., Rønningen, H., Lund-Larsen, J., Benum, P. & **Grande, L.** (2004). Impacted bone stiffness measured during construction of morsellised bone samples. *Journal of Biomechanics*. 37, 11, 1757-1766. DOI: 10.1016/j.jbiomech.2004.01.022.

Hall, C.M., Aso, T., Tsutsumi, M., Hoffner, J. & **Sigernes, F.** (2004). Multi-instrument derivation of 90 km temperatures over Svalbard (78 degrees N 16 degrees E). *Radio Science*. 39, 6. DOI: 10.1029/2004RS003069.

Hammarlund, D., Velle, G., Wolfe, B.B., Edwards, T.W.D., Bamekow, L., Bergman, J., **Holmgren, S.**, Lamme, S., Snowball, I., Wohlfarth, B. & Possnert, G. (2004). Palaeolimnological and sedimentary responses to holocene forest retreat in the Scandes mountains, west-central Sweden. *Holocene*. 14, 6, 862-876.

**Hole, L.R.**, Semb, A. & Torseth, K. (2004). Ozone deposition to a temperate coniferous forest in Norway : gradient method measurements and comparison with the EMEP deposition module. *Atmospheric Environment*. 38, 15, 2217-2223.

**Kuklinski, P.** & Hayward, P.J. (2004). Two new species of cheilostome Bryozoa from Svalbard. *Sarsia*. 89, 2, 79-84.

**Kuklinski, P.** & Porter, J.S. (2004). *Alcyonidium disciforme* : an exceptional arctic bryozoan. *Journal of the Marine Biological Association of the United Kingdom*. 84, 1, 267-275.

**Langvatn, R.**, Mysterud, A. & Stenseth, N.C. (2004). Relationships in red deer *Cervus elaphus* mandibles. *Acta Theriologica*. 49, 4, 527-542.

**Langvatn, R.**, Mysterud, A., Stenseth, N.C. & Yoccoz, N.G. (2004). Timing and synchrony of ovulation in red deer constrained by short northern summers. *American Naturalist*. 163, 5, 763-772.

**Liferov, P.** (2004). Ice rubble behaviour and strength : Part II. Modelling. *Cold Regions Science and Technology*. 41, 2, 153-163. DOI: 10.1016/j.coldregions.2004.10.002.

**Liferov, P.** & Bonnemaire, B. (2004). Ice rubble behaviour and strength : Part I. Review of testing and interpretation of results. *Cold Regions Science and Technology*. 41, 2, 135-151. DOI: 10.1016/j.coldregions.2004.10.001.

**Liferov, P.** & **Høyland, K.V.** (2004). In-situ ice ridge scour tests : experimental set up and basic results. *Cold Regions Science and Technology*. 40, 1-2, 97-110. DOI: 10.1016/j.coldregions.2004.06.003.

**Loe, L.E.**, Meisingset, E.L., Mysterud, A., **Langvatn, R.** & Stenseth, N.C. (2004). Phenotypic and environmental correlates of tooth eruption in red deer (*Cervus elaphus*). *Journal of Zoology*. 262, 83-89.

Loison, A., Solberg, E.J., Yoccoz, N.G. & **Langvatn, R.** (2004). Sex differences in the interplay of cohort and mother quality on body mass of red deer calves. *Ecology*. 85, 7, 1992-2002.

**Lorentzen, D.A.**, Shumilov, N. & **Moen, J.** (2004). Drifting airglow patches in relation to tail reconnection. *Geophysical Research Letters*. 31, 2. DOI: 10.1029/2003GL017785.

Moros, M., McManus, J.F., **Rasmussen, T.L.**, Kuijpers, A., Dokken, T., Snowball, I., **Nielsen, T.** & Jansen, E. (2004). Quartz content and the quartz-to-plagioclase ratio determined by X-ray diffraction : a proxy for ice rafting in the northern North Atlantic? *Earth and Planetary Science Letters*. 218, 3-4, 389-401. DOI: 10.1016/S0012-821X(03)00675-7.

Mysterud, A., **Langvatn, R.** & Stenseth, N.C. (2004). Patterns of reproductive effort in male ungulates. *Journal of Zoology*. 264, 209-215.

Nelson, F.E., Shiklomanov, N.I., **Christiansen, H.H.** & Hinkel, K.M. (2004). The circumpolar-active-layer-monitoring (CALM) workshop : introduction. *Permafrost and Periglacial Processes*. 15, 2, 99-101. DOI: 10.1002/ppp.488.

**Nilsen, F.** (2004). Forcing of a two-layered water column over a sloping seafloor. *Journal of Physical Oceanography*. 34, 12, 2659-2676. DOI:

10.1175/JPO2638.1.

Nybakken, L., Bilger, W., Johanson, U., Björn, L.O., **Zielke, M.** & Solheim, B. (2004). Epidermal UV-screening in vascular plants from Svalbard (Norwegian Arctic). *Polar Biology*. 27, 7, 383-390. DOI: 10.1007/s00300-004-0601-9.

Ohman, M.D., **Eiane, K.**, Durbin, E.G., Runge, J.A. & Hirche, H.J. (2004). A comparative study of *Calanus finmarchicus* mortality patterns at five localities in the North Atlantic. *ICES Journal of Marine Science*. 61, 4, 687-697.

Okamoto, T., Larsen, J.O., Matsuura, S., Asano, S., Takeuchi, Y. & **Grande, L.** (2004). Displacement properties of landslide masses at the initiation of failure in quick clay deposits and the effects of meteorological and hydrological factors. *Engineering Geology*. 72, 3-4, 233-251.

Pryse, S.E., Sims, R.W., **Moen, J.**, Kersley, L., **Lorentzen, D.A.** & Denig, W.F. (2004). Evidence for solar-production as a source of polar-cap plasma. *Annales Geophysicae*. 22, 4, 1093-1102.

**Rasmussen, T.L.** & Thomsen, E. (2004). The role of the North Atlantic drift in the millennial timescale glacial climate fluctuations. *Palaeogeography Palaeoclimatology Palaeoecology*. 210, 1, 101-116.

**Skogseth, R.**, Haugan, P.M. & Haarpaintner, J. (2004). Ice and brine production in Storfjorden from four winters of satellite and in situ observations and modeling. *Journal of Geophysical Research-Oceans*. 109, C10. DOI: 10.1029/2004JC002384.

Solheim, B., Wiggen, H., **Røberg, S.** & Spaik, H.P. (2004). Associations between arctic cyanobacteria and mosses. *Symbiosis*. 37, 1-3, 169-187.

**Veiberg, V.**, **Loe, L.E.**, Mysterud, A., **Langvatn, R.** & Stenseth, N.C. (2004). Social rank, feeding and winter weight loss in red deer : any evidence of interference competition? *Oecologia*. 138, 1, 135-142.

Wooler, M.J., Francis, D., Fogel, M.L., Miller, G.H., Walker, I.R. & **Wolfe, A.P.** (2004). Quantitative paleotemperature estimates from  $\delta^{18}\text{O}$  of chironomid head capsules preserved in arctic lake sediments. *Journal of Paleolimnology*. 31, 3, 267-274.

## SCIENTIFIC PUBLICATIONS BY ADJUNCT PROFESSORS

These publications may also occur in the annual reports of the adjunct professors home institution.

Andersen, S.M., Lydersen, C., Grahl-Nielsen, O. & **Kovacs, K.M.** (2004). Autumn diet of harbour seals (*Phoca vitulina*) at Prins Karls Forland, Svalbard, assessed via scat and fatty-acid analyses. *Canadian Journal of Zoology*. 82, 8, 1230-1245. DOI: 10.1139/Z04-093.

Augustin, L., Barbante, C., Barnes, P.R.F., Barnola, J.M., Bigler, M., Castellano, E., Cattani, O., Chappellaz, J., Dahl-Jensen, D., Delmonte, B., Dreyfus, G., Durand, G., Falourd, S., Fischer, H., Fluckiger, J., Hansson, M.E., Huybrechts, P., Jugie, R., Johnsen, S.J., Jouzel, J., Kaufmann, P., Kipfstuhl, J., Lambert, F., Lipenkov, V.Y., Littot, G.V.C., Longinelli, A., Lorrain, R., Maggi, V., Masson-Delmotte, V., Miller, H., Mulvaney, R., Oerlemans, J., Oerter, H., Orombelli, G., Parrenin, F., Peel, D.A., Petit, J.R., Raynaud, D., Ritz, C., Ruth, U., Schwander, J., Siegenthaler, U., Souchez, R., Stauffer, B., Steffensen, J.P., Stenni, B., Stocker, T.F., Tabacco, I.E., Udisti, R., van De Wal, R.S.W., van Den Broeke, M., Weiss, J., Wilhelms, F., **Winther, J.G.**, Wolff, E.W. & Zucchelli, M. (2004). Eight glacial cycles from an Antarctic ice core. *Nature*. 429, 6992, 623-628. DOI: 10.1038/nature02599.

Carlson, H.C., Oksavik, K., **Moen, J.** & Pedersen, T. (2004). Ionospheric patch formation: direct measurements of the origin of a polar cap patch. *Geophysical Research Letters*. 31, 8. DOI: 10.1029/2003GL018166.

Chauton, M.S., Tilstone, G.H., Legrand, C. & **Johnsen, G.** (2004). Changes in pigmentation, bio-optical characteristics and photophysiology, during phytoflagellate succession in mesocosms. *Journal of Plankton Research*. 26, 3, 315-324.

Clason, B., **Gulliksen, B.** & Zauke, G.P. (2004). Assessment of two-compartment models as predictive tools for the bioaccumulation of trace metals in the amphipod *Gammarus oceanicus* Segerstråle, 1947 from Grunnfjord (Northern Norway). *Science of the Total Environment*. 323, 1-3, 227-241.

Eriksson, M., **Holm, E.**, Roos, P. & Dahlgaard, H. (2004). Distribution and flux of  $^{238}\text{Pu}$ ,  $^{239,240}\text{Pu}$ ,  $^{241}\text{Am}$ ,  $^{137}\text{Cs}$  and  $^{210}\text{Pb}$  to high arctic lakes in the Thule district (Greenland). *Journal of Environmental Radioactivity*. 75, 3, 285-299. DOI: 10.1016/j.jenvrad.2003.12.007.

Foldvik, A., **Gammelsrød, T.**, Østerhus, S., Fahrback, E., Rohardt, G., Schröder, M., Nicholls, K.W., Padman, L. & Woodgate, R.A. (2004). Ice shelf water overflow and bottom water formation in the southern Weddell Sea. *Journal of Geophysical Research-Oceans*. 109, C2, C02015. DOI: 10.1029/2003JC002008.

Forman, S.L., Lubinski, D.J., **Ingólfsson, Ó.**, Zeeberg, J.J., Snyder, J.A., Siegert, M.J. & Matisov, G.G. (2004). A review of postglacial emergence on Svalbard, Franz Josef Land and Novaya Zemlya, northern Eurasia. *Quaternary Science Reviews*. 23, 11-13, 1391-1434.

Gjølsteen, J.K.O. & **Løset, S.** (2004). Laboratory experiments on oil spreading in broken ice. *Cold Regions Science and Technology*. 38, 2-3, 103-116. DOI: 10.1016/j.coldregions.2003.10.004.

Hamre, B., **Winther, J.G.**, Gerland, S., Stamnes, J.J. & Stamnes, K. (2004). Modeled and measured optical transmittance of snow-covered first-year sea ice in Kongsfjorden, Svalbard. *Journal of Geophysical Research-Oceans*.

109, C10. DOI: 10.1029/2003JC001926.

Hasholt, B., Hansen, B.U., **Humlum, O.** & Mernild, S.H. (2004). Meteorological stations at the Sermilik station, southeast Greenland : physical environment and meteorological observations 2002. *Geografisk tidsskrift*. 104, 1, 47-58.

**Havnes, O.** (2004). Polar mesospheric summer echoes (PMSE) overshoot effect due to cycling of artificial electron heating. *Journal of Geophysical Research-Space Physics*. 109, A02309. DOI: 10.1029/2003JA010159.

**Havnes, O.**, La Hoz, C., Biebricher, A., Kassa, M., Meseret, T., Næsheim, I. & Zivkovic, T. (2004). Investigation of the mesospheric PMSE conditions by use of the new overshoot effect. *Physica Scripta : Topical Issue*. 107, 70-79.

Hofstede, C.M., van de Wal, R.S.W., Kaspers, K.A., van den Broeke, M.R., Karlöf, L., **Winther, J.G.**, Isaksson, E., Lappegard, G., Mulvaney, R., Oerter, H. & Wilhelms, F. (2004). Firn accumulation records for the past 1000 years on the basis of dielectric profiling of six cores from Dronning Maud Land, Antarctica. *Journal of Glaciology*. 50, 169, 279-291.

Horányi, M., Hartquist, T.W., **Havnes, O.**, Mendis, D.A. & Morfill, G.E. (2004). Dusty plasma effects in Saturn's magnetosphere. *Reviews of Geophysics*. 42, 4. DOI: 10.1029/2004RG000151.

Huang, D.H., **Moen, J.**, **Brekke, A.**, Yang, H.G. & Liu, R.Y. (2004). A study on the Zhongshan conjugate point location during auroral substorms. *Chinese Journal of Geophysics*. 47, 1, 54-60.

Kaspers, K.A., van de Wal, R.S.W., De Gouw, J.A., Hofstede, C.M., van den Broeke, M.R., Reijmer, C.H., van der Veen, C., Neubert, R.E.M., Meijer, H.A.J., Brenninkmeijer, C.A.M., Karlöf, L. & **Winther, J.G.** (2004). Seasonal cycles of nonmethane hydrocarbons and methyl chloride, as derived from firn air from Dronning Maud Land, Antarctica. *Journal of Geophysical Research-Atmospheres*. 109, D16. DOI: 10.1029/2004JD004629.

Kaspers, K.A., van de Wal, R.S.W., De Gouw, J.A., Hofstede, C.M., van den Broeke, M.R., van der Veen, C., Neubert, R.E.M., Meijer, H.A.J., Brenninkmeijer, C.A.M., Karlöf, L. & **Winther, J.G.** (2004). Analyses of firn gas samples from Dronning Maud Land, Antarctica : study of nonmethane hydrocarbons and methyl chloride. *Journal of Geophysical Research-Atmospheres*. 109, D2. DOI: 10.1029/2003JD003950.

König, M., **Winther, J.G.**, Kohler, J. & König, F. (2004). Two methods for firn-area and mass-balance monitoring of Svalbard glaciers with SAR satellite images. *Journal of Glaciology*. 50, 168, 116-128.

Lesage, V., Hammill, M.O. & **Kovacs, K.M.** (2004). Long-distance movements of harbour seals (*Phoca vitulina*) from a seasonally ice-covered area, the St. Lawrence River estuary, Canada. *Canadian Journal of Zoology*. 82, 7, 1070-1082. DOI: 10.1139/Z04-084.

Lindahl, P., Roos, P., Eriksson, M. & **Holm, E.** (2004). Distribution of Np and Pu in Swedish lichen samples (*Cladonia stellaris*) contaminated by

atmospheric fallout. *Journal of Environmental Radioactivity*. 73, 1, 73-85. DOI: 10.1016/j.jenvrad.2005.01.011.

Lydersen, C., **Nøst, O.A.**, **Kovacs, K.M.** & Fedak, M.A. (2004). Temperature data from Norwegian and Russian waters of the northern Barents sea collected by free-living ringed seals. *Journal of Marine Systems*. 46, 1-4, 99-108.

Mathews, J.T., Mann, I.R., Rae, I.J. & **Moen, J.** (2004). Multi-instrument observations of ULF wave-driven discrete auroral arcs propagating sunward and equatorward from the poleward boundary of the duskside auroral oval. *Physics of Plasmas*. 11, 4, 1250-1259.

Maynard, N.C., **Moen, J.**, Burke, W.J., Lester, M., Ober, D.M., Scudder, J.D., Siebert, K.D., Weimer, D.R., Russe, C.T. & Balogh, A. (2004). Temporal-spatial structure of magnetic merging at the magnetopause inferred from 557.7-nm all-sky images. *Annales Geophysicae*. 22, 8, 2917-2942.

**Moen, J.**, Lockwood, M., Oksavik, K., Carlson, H.C., Denig, W.F., van Eyken, A.P. & McCrea, I.W. (2004). The dynamics and relationships of precipitation, temperature and convection boundaries in the dayside auroral ionosphere. *Annales Geophysicae*. 22, 6, 1973-1987.

**Moen, J.**, Oksavik, K. & Carlson, H.C. (2004). On the relationship between ion upflow events and cusp auroral transients. *Geophysical Research Letters*. 31, 11. DOI: 10.1029/2004GL020129.

Nadim, F., Moghtaderi-Zadeh, M., Lindholm, C., **Andresen, A.**, Remseth, S., Bolourchi, M., Mokhtari, M. & Tvedt, E. (2004). The Bam earthquake of 26 December 2003. *Bulletin of Earthquake Engineering*. 2, 2, 119-153. DOI: 10.1007/s10518-004-2286-4.

**Nøst, O.A.** (2004). Measurements of ice thickness and seabed topography under the Fimbul Ice Shelf, Dronning Maud Land, Antarctica. *Journal of Geophysical Research-Oceans*. 109, C10. DOI: 10.1029/2004JC002277.

Oksavik, K., **Moen, J.** & Carlson, H.C. (2004). High-resolution observations of the small-scale flow pattern associated with a poleward moving auroral form in the cusp. *Geophysical Research Letters*. 31, 11. DOI: 10.1029/2004GL019838.

Oksavik, K., Søråas, F., **Moen, J.**, Pfaff, R., Davies, J.A. & Lester, M. (2004). Simultaneous optical, CUTLASS HF radar, and FAST spacecraft observations : signatures of boundary layer processes in the cusp. *Annales Geophysicae*. 22, 2, 511-525.

Pomponi, M.G.E., Bertonati, C., Derocher, A.E., Lydersen, C., Wiig, Ø. & **Kovacs, K.M.** (2004). Hemoglobin, pH and DPG/chloride shifting. *Biochimie*. 86, 12, 927-932.

Rasmussen, G. & **Olsen, R.A.** (2004). Sorption and biological removal of creosote-contaminants from groundwater in soil/sand vegetated with orchard grass (*Dactylis glomerata*). *Advances in Environmental Research*. 8, 3-4, 313-327.

Steltenpohl, M.G., Hames, W.E. & **Andresen, A.** (2004). The silurian to permian history of a metamorphic core complex in Lofoten, Northern Scandinavian Caledonides. *Tectonics*. 23, 1. DOI: 10.1029/2003TC001522.

Svendsen, J.I., Alexanderson, H., Astakhov, V.I., Demidov, I., Dowdeswell, J.A., Funder, S., Gataullin, V., Henriksen, M., Hjort, C., Houmark-Nielsen, M., Hubberten, H.W., **Ingólfsson, Ó.**, Jakobsson, M., Kjær, K.H., Larsen, E., Lokrantz, H., Lunkka, J.P., Lysa, A., Mangerud, J., Matiouchkov, A., Murray, A., Möller, P., Niessen, F., Nikolskaya, O., Polyak, L., Saarnisto, M., Siegert, C., Siegert, M.J., Spielhagen, R.F. & Stein, R. (2004). Late quaternary ice sheet history of northern Eurasia. *Quaternary Science Reviews*. 23, 11-13, 1229-1271.

Trefffeisen, R., Herber, A., Ström, J., Shiobara, M., Yamagata, T.Y., **Holmén, K.**, Kriews, M. & Schrems, O. (2004). Interpretation of Arctic aerosol properties using cluster analysis applied to observations in the Svalbard area. *Tellus Series B-Chemical and Physical Meteorology*. 56, 5, 457-476. DOI: 10.1111/j.1600-0889.2004.00128.x.

Urashima, T., Nakamura, T., Nakagawa, D., Noda, M., Arai, I., Saito, T., Lydersen, C. & **Kovacs, K.M.** (2004). Characterization of oligosaccharides in milk of bearded seal (*Erignathus barbatus*). *Comparative Biochemistry and Physiology B-Biochemistry & Molecular Biology*. 138, 1, 1-18.

van Parijs, S.M., Lydersen, C. & **Kovacs, K.M.** (2004). Effects of ice cover on the behavioural patterns of aquatic-mating male bearded seals. *Animal Behaviour*. 68, 89-96. DOI: 10.1016/j.anbehav.2003.09.013.

**Winther, J.G.**, Edvardsen, K., Gerland, S. & Hamre, B. (2004). Surface reflectance of sea ice and under-ice irradiance in Kongsfjorden, Svalbard. *Polar Research*. 23, 1, 115-118.

Wolkers, H., Lydersen, C. & **Kovacs, K.M.** (2004). Accumulation and lactational transfer of PCBs and pesticides in harbor seals (*Phoca vitulina*) from Svalbard, Norway. *Science of the Total Environment*. 319, 1-3, 137-146.

Wolkers, H., van Bavel, B., Derocher, A.E., Wiig, O., **Kovacs, K.M.**, Lydersen, C. & Lindstrøm, G. (2004). Congener-specific accumulation and food chain transfer of polybrominated diphenyl ethers in two arctic food chains. *Environmental Science & Technology*. 38, 6, 1667-1674.

Zalizovski, A., Kashcheyev, S., Yampolski, Y., Galushko, V., Belyey, V., Isham, B.C., Rietveld, M.T., La Hoz, C., **Brekke, A.**, Blagoveshenskaya, N. & Komiienko, V.A. (2004). Spectral features of HF signals from the EISCAT heating facility in Europe and in Antarctica. *Radiofizika i radioastronomiia*. 9, 9, 261-273.

Zhdanov, S.K., Morfill, G.E., Samsonov, D., Zuzic, M. & **Havnes, O.** (2004). Origin of the curved nature of Mach cone wings in complex plasmas. *Physical Review E*. 69, 2. DOI: 10.1103/PhysRevE.69.026407.

## BOOKS AND CHAPTERS IN BOOKS

**Arlov, T.B.** (2004). Den første ishavsbøen. pp. 9-45. *In:* Norsk polarhistorie. Oslo: Gyldendal. pp. 595. ISBN: 82-05-32657-6.

**Arlov, T.B.** (2004). Kulldrift i kald krig. pp. 389-441. *In:* Norsk polarhistorie. Oslo: Gyldendal. pp. 595. ISBN: 82-05-32657-6.

**Arlov, T.B.** (2004). UNIS - Universitetspolitikk eller suverenitetspolitikk? pp. 129-138. *In:* Inn i riket : Svalbard, Nord-Norge og Norge : rapport fra det 28. nordnorske historieseminar, Longyearbyen 3.-5.10.2003. Tromsø: Institutt for historie, Universitetet i Tromsø. pp. 142. (Speculum Boreale). ISBN: 82-92201-07-6.

**Gulliksen, B.** & Svendsen, E. (2004). Svalbard and life in polar oceans. Kristiansund: Kom. pp. 160. ISBN: 82-92496-03-3.

**Gulliksen, B.** & Svendsen, E. (2004). Svalbard og dyreliv i polare hav. Kristiansund: Kom. pp. 160. ISBN: 82-92496-17-3.

Hjort, C. & **Ingólfsson, Ó.** (2004). Otto Nordenskjöld's contribution to glaciation history : a bipolar effort with a southern focus. pp. 188-199. *In:* Elzinga, A., Nordin, T., Turner, D. & Wråkberg, U. (eds.). Antarctic challenges : historical and current perspectives on Otto Nordenskjöld's Antarctic expedition 1901-1903. Göteborg: Royal Society of Arts and Sciences. pp. 330. (Acta Regiae Societatis scientiarum et litterarum Gothoburgensis. Interdisciplinaria). ISBN: 91-85252-64-6.

**Jónsdóttir, I.S.** & Moen, J. (2004). Botany in the West Antarctic region : from Skottsberg to modern research. pp. 156-174. *In:* Elzinga, A., Nordin, T., Turner, D. & Wråkberg, U. (eds.). Antarctic challenges : historical and current perspectives on Otto Nordenskjöld's Antarctic expedition 1901-1903. Göteborg: Royal Society of Arts and Sciences. pp. 330. (Acta Regiae Societatis scientiarum et litterarum Gothoburgensis. Interdisciplinaria). ISBN: 91-85252-64-6.

**Kovacs, K.M.**, Gjertz, I. & Lydersen, C. (2004). Marine mammals of Svalbard. Tromsø: Norwegian Polar Institute. pp. 64. ISBN: 82-7666-208-0.

# Guest lecturers 2004

Name	Institution	Name	Institution
Abrahamsen, Povl Albert, Mary	University of Bergen , Norway USACE Engineer Research and Development Center, Cold regions Research and Engineering Laboratory	Grande, Lars	Norwegian University of Science and Technology
Alfredsen, Knut	Norwegian University of Science and Technology	Grydeland, Tom	University of Tromsø, Norway
Alm, Göran	Stockholm University, Sweden	Grøndahl, Kirsti Kolle	Fylkesmannen i Buskerud, Norway
Andresen, Steinar	University of Oslo , Norway	Gudmestad, Ove Tobias	Statoil, Norway
Asplin, Lars	Institute for Marine Research, Norway	Guio, Patrick	University of Oslo, Norway
Astakhov, Valery	Institute for Remote Sensing Methods in Geology, Russia	Hancke, Kasper	Norwegian University of Science and Technology
Austegård, Atle	University of Bergen , Norway	Hanssen-Bauer, Inger	DNMI, Norway
Bardgett, Richard D.	Lancaster University, UK	Haug, Tore	Norwegian Institute of Fisheries and Aquaculture
Beldring, Stein	MVE, Norway	Heia, Karsten	Norwegian institute of Fisheries and Aquaculture
Benn, Doug	University of St. Andrews, UK	Hjøllo, Solfrid	University of Bergen, Norway
Berggren, Anne-Lise	Geofrost Engineering A/S, Norway	Hodkinson, Ian D.	Liverpool John Moores University, UK
Björnsson, Helgi	University of Iceland	Hormes, Anne	Uppsala University, Sweden
Bjørnå, Noralv	University of Tromsø , Norway	Hop, Haakon	Norwegian Polar Institute
Blikra, Lars Harald	The Geological Survey of Norway	Hovelsrud-Broda, Grete	NAMMCO, Norway
Blixt, Märten	University of Tromsø , Norway	Høgda, Kjell Arild	NORUT IT, Norway
Bogen, Jim Jens	Norwegian water resorces and energy administration	Høydal, Anne	University of Tromsø, Norway
Briner, Jason	INSTAAR, University of Colorado, USA	Haagensen, Per J.	Norwegian University of Science and Technology
Braathen, Alvar	Centre for Integrated Petroleum Research, University of Bergen , Norway	Ims, Rolf A.	University of Tromsø, Norway
Cleveland, Frank	University of Bergen , Norway	Ingolfsson, Ólafur	Department of Geology and Geography, University of Iceland
Daling, Per	SINTEF, Norway	Instanes, Arne	Instanes A/S, Norway
Darelius, Elin	University of Bergen , Norway	Isham, Brett	EISCAT, Norway
De Lange, Tor	University of Bergen , Norway	Jaedicke, Christian	Norwegian Geotechnical Institute
Ditlevsen, May Kristin	SINTEF, Norway	Jaldemark, Kristian	Carmenta AB, Sweden
Dokken, Trond	University of Bergen , Norway	Janssen, Eystein	Bjerkens Center, University of Bergen, Norway
Dowdeswell, Julian	University of Cambridge, UK	Jansson, Peter	Stockholm University, Sweden
Egeland, Alv	University of Oslo , Norway	Jensen, Bjørn Munro	Norwegian University of Science and Technology
Eiken, Trond	University of Oslo , Norway	Jeppesen, Jon W.	Freelance, Denmark
Elberling, Bo	University of Copenhagen, Denmark	Jessen, Simon	University Centre in Svalbard, Norway / University of Copenhagen, Denmark
Falk-Pedersen, Stig	Norwegian Polar Institute	Kahnert, Michael	SMHI, Sweden
Fevolden, Svein-Erik	University of Tromsø , Norway	Kallenborn, Roland	The Norwegian Institute for Air Research
Finch, Ivan	Rutherford Appleton Laboratory, UK	Kangas, Tor-Willy	Institute for Marine Research, Norway
Finseth, Jomar	Norwegian University of Science and Technology	Killingtveit, Ånud	Norwegian University of Science and Technology
Forman, Steven	University of Illinois, USA	Kjærnet, Torfinn	Bergmesteren for Svalbard, Norway
Forwick, Matthias	University of Tromsø , Norway	Kobro, Grethe	Agricultural University of Norway
Fuglei, Eva	Norwegian Polar Institute	Koyi, Hemin	Uppsala University, Sweden
Funder, Svend	Geological Museum, University of Copenhagen, Denmark	Krapp, Rupert	Institut f. Polarökologie, University of Kiel, Germany
Furuvik, Tore	University of Bergen , Norway	Kristensen, Dorte Klitgaard	University of Bergen, Norway
Gabrielsen, Geir Wing	Norwegian Polar Institute	Kuhn, Michael	University of Innsbruck, Austria
Gerdes, Birte	Alfred Wagner Inst. - AWI, Germany	Kuvaas, Berit	University of Bergen, Norway
Gjevik, Bjørn	University of Oslo, Norway	Kwasniewski, Slawek	Polish Academy of Sciences
Gjøsæter, Harald	Institute for Marine Research, Norway		
Goering, Douglas	University of Alaska, USA		

Name	Institution	Name	Institution
La Hoz, Cesar	University of Tromsø, Norway	Snowball, Ian	Lund University, Sweden
Laberg, Jan Sverre	University of Tromsø, Norway	Solheim, Bjørn	University of Tromsø, Norway
Landvik, Jon	Agricultural University of Norway	Solheim, Jan Erik	University of Oslo, Norway
Lappegard, Gaute	University of Oslo, Norway	Sorteberg, Asgeir	University of Bergen, Norway
Leppäranta, Matti	University of Helsinki, Finland	Stenseth, Nils Chr.	University of Oslo, Norway
Liferov, Pavel	Norwegian University of Science and Technology	Stette, Gunnar	Norwegian University of Science and Technology
Lundén, Bengt	Stockholm University, Sweden	Storvold, Rune	NORUT Information Technology Ltd, Norway
Lønnum, Lasse	Norwegian Polar Institute	Strømme, Anja	EISCAT, Norway
Malaize, Bruno	University of Bordeaux, France	Sundet, Jan	Norwegian Institute of Fisheries and Aquaculture
Maljutin, Arkady	Rubin Central Design Bureau for Marine Engineering	Sundvor, Eirik	University of Bergen, Norway
McPhee, Miles	McPhee Research Company, USA	Svenning, Martin	Norwegian Institute for Nature Research
Mehlum, Fridtjof	The Research Council of Norway	Svenøe, Trond	Norwegian Polar Institute
Mitchenko, Igor	Gupkin University of oil and gas, Russia	Sælthun, Nils	NIVA, Norway
Mjelde, Rolf	University of Bergen, Norway	Sæther, Ola Magne	The Geological Survey of Norway
Morison, James	University of Washington, USA	Telebond, Turid	Svalbard Samfunnsdrift, Norway
Myking, Steinar	University of Bergen, Norway	Toudal, Leif	Technical University of Denmark
Myrvang, Arne	Norwegian University of Science and Technology	Tverberg, Vigdis	Norwegian Polar Institute
Maattanen, Mauri	Helsinki Technical University, Finland	Tørseth, Kjetil	NILU, Norway
Nagy, Jenő	University of Oslo, Norway	Ulfstein, Geir	University of Oslo, Norway
Nemec, Wojtec	University of Bergen, Norway	Vaskinn, Kjetil Arne	Statkraft Grøner AS, Norway
Nerland, Ørjan	Norwegian Geotechnical Institute	Volent, Zsolt	SINTEF, Norway
Nilsen, Jan Even Øie	Nansensenteret, Norway	von Quillfeldt, Cecilie	Norwegian Polar Institute
Notz, Dirk	University of theoretical Geophysics/DAMTP, University of Cambridge, UK	Walløe, Lars	University of Oslo, Norway
Nøttvedt, Arvid	Norsk Hydro, Norway	Wold, Anette	Norwegian Polar Institute
Oksavik, Kjellmar	Norwegian University of Science and Technology	Wiig, Øystein	University of Oslo, Norway
Olsen, Vegard	University of Oslo, Norway	Zolotukhin, Anatoly	Statoil, Norway
Prestrud, Pål	CICERO, University of Oslo, Norway	Øritsland, Nils A.	Norwegian Institute for Nature Research
Prick, Angelique	University of Liege	Østerhus, Svein	University of Bergen, Norway
Ramstad, Svein	SINTEF, Norway	Øverås, Lise	University of Bergen, Norway
Raustein, Elmer	University of Bergen, Norway		
Reed, Mark	SINTEF, Norway		
Rees, David	Université du Quebec a Rimouski, Canada		
Reymert, Per Kyrre	Tromsø Museum, Norway		
Roemer, Stephan	Inst. of Aero- and Astronautics, Germany		
Ruud, Bent Ole	University of Bergen, Norway		
Rytter, Jens	GFI, University of Bergen, Norway		
Röttger, Jürgen	Max Plank Institut für Aeronomie, Germany		
Sand, Knut	Statkraft Grøner AS, Norway		
Shkhinek, Karl	State Technical University of St. Petersburg, Russia		
Siggerud, Erling I Heintz	PGS Reservoir AS, Norway		
Sjöblom, Anna	Bjerknes Centre for Climate Research, University of Bergen		
Skardhamer, Jofrid	Akvaplan NIVA, Norway		



[www.unis.no](http://www.unis.no)

The University Centre in Svalbard  
P.O.Box 156 - N-9171 Longyearbyen - Norway

Tel. +47 7902 3300 - Fax +47 7902 3301  
E-mail: [studadm@unis.no](mailto:studadm@unis.no)